

CERTIFIED LAND CORNER RESTORATION

33-12

Index No. H-22

State of Wisconsin }
County of LANGLADE } ss.

I, ROBERT J. POSS, do hereby certify that on the 20TH day of JUNE, 1968, I found evidence of the SOUTHWEST 1/16 corner of SEC. 12- Township 33, North, Range 12 EAST, Fourth, Principal Meridian, as described hereon; and that from this evidence I established a new monument and accessories as described hereon to perpetuate the original location of this corner.

Resident witnesses:

FORM 985 M. C. MILLER CO., MILWAUKEE

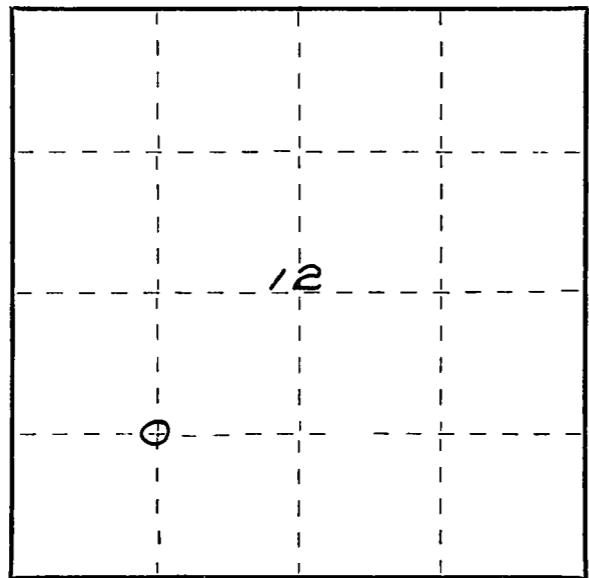

○ = Corner monument restored.

History of original corner establishment:

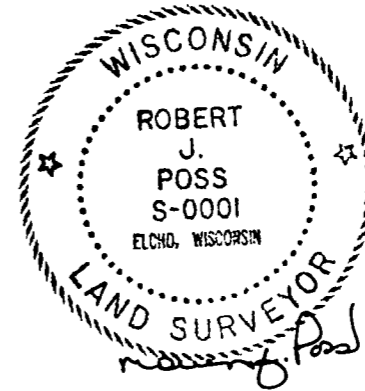

Description of corner evidence found:

FOUND 1/4" GALV. IRON PIPE - LAND AROUND CLEARED FOR NEW ROAD LOCATION.
11/17/95 D. TLUSTY (WC) FOUND IP WITH CAP & ASPEN STUMP ALL OTHER TIES GONE. PIPE IS 35' E FROM E OLD "T" & AT SOUTH EDGE OF FILL ON NEW "T". PAINTED TREES AROUND IT BLUE

Description of monument and accessories I established to perpetuate the original location of this corner.

SET WITNESS COR.

1/4" GALV. IRON PIPE
○ 1/4 IRON PIPE MKD.
SW 1/16 SEC. 12
1 RD NORTH.

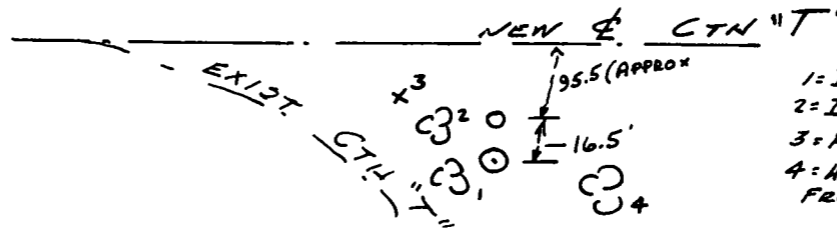

ALL TREES BLAZE & SCRIBED NBY
1= IRONWOOD 12577 1/2 W 20.1
2= IRONWOOD 8 N 76 1/2 W
3= PWR. POLE N 86 W 51.8 X POWER POLE NO MARK. FROM W.C.
4= ASPEN 16565 3/4 E 8.3

Dated at ELCHO, Wis., this 20TH day of JUNE, 1968.

Signature Robert J. Poss Title REG. LAND SURVEYOR Registration No. S-1
(County Surveyor, Registered Land Surveyor, or other duly authorized official)

Office of Register of Deeds, County of _____, I hereby certify that the within instrument was filed in this office for record on the _____ day of _____, 19 _____ at _____ o'clock _____ M.

(Register of Deeds)

By _____ Deputy