

# U. S. PUBLIC LAND SURVEY MONUMENT RECORD

**INSTRUCTIONS:**

This record shall show the location of the corner and shall include all of the following nine elements (a through i).

- (a) Identify the corner by reference to the U.S. public land survey system.  
 ● = Corner monument restored.

East Quarter corner,  
 Section 11,  
 Township 33 North,  
 Range 12 East,  
 Langlade County,  
 Wisconsin.

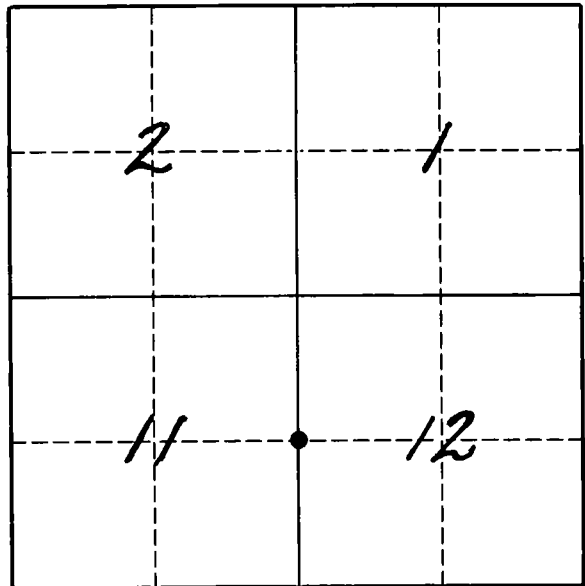

T. 33 N., R 12 E.

- (b) Describe any record evidence, monument evidence, occupational evidence, testimonial evidence or any other material evidence you considered, and whether the monument was found or placed.

The original corner was set in 1865 by James Nowlin, Deputy Surveyor. Original bearing trees: Hemlock, 12", N40W, 35 lks (23.1'), and a White pine, 28", N68E, 25 lks (16.5'). Mr. Ivan Schmidt, longtime adjoining landowner, pointed out an iron pipe that now sets where an old wood post used to be. From this iron pipe, there is a white pine stump to the northeast that exactly fits the original survey BT call. I accept the location of the iron pipe as the location of the original corner, and in its place, I set a 2" x 48" aluminum pipe monument with 3 1/4" aluminum cap and magnet. Top of monument is 0.3' above ground in a mound of stones.

- (c) In the plan view drawing below, provide reference ties to at least 4 witness monuments, or, if the location is within a municipality, to at least 2 witness monuments. (Witness monuments shall be made of concrete, natural stone, iron or other equally durable material.)

Describe witness monuments.

 = Bearing tree with BT sign facing corner with bark smoothed blue paint band at 5' above ground. Tie distance is to an aluminum nail in a small, low blaze on the left side of the tree. BT bearing is magnetic using a hand compass.

- (d) Show a plan view drawing depicting the relevant monuments and reference ties which is sufficient in detail to enable accurate relocation of the corner monument if the corner monument is disturbed. Indicate north.

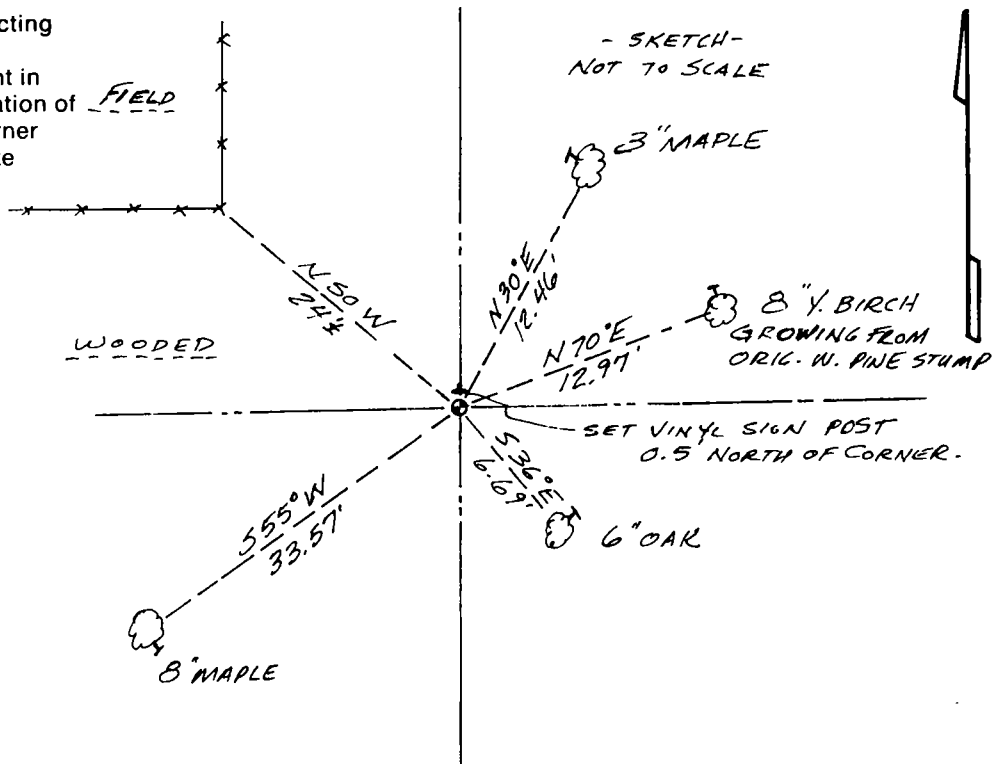

Describe any material discrepancy between the location of the corner as restored or reestablished and the location of that corner as previously restored or reestablished by distance and direction. Show the discrepancy on the plan view drawing under (d), above. Show the distances between the corner as previously restored or reestablished and (1) the corner as restored or reestablished, and (2) to at least 2 of the witness monuments shown on the drawing in (d), above.

No discrepancy.

(f) Was the corner restored through acceptance of (1) an obliterated evidence location, or, (2) a found perpetuated location?  
A found perpetuated location.

(g & h) Was the corner reestablished through lost corner proportionate methods? If so, show the method, including the directions and distances to other public land survey corners used as evidence or used for proportioning in determining the corner location.

No.

(i) I, David E. Tlusty, Langlade County Surveyor  
(type or print name)

certify that the corner location shown on this record was determined by me or under my direction and control and that this U.S. Public Land Survey Monument Record is correct and complete to the best of my knowledge and belief.



David E. Tlusty 8/23/93  
Signature Date