

CERTIFIED LAND CORNER RESTORATION

33-12

Index No. J-21

State of Wisconsin }
County of Lancaster } ss.

I, Raymond Hallist, do hereby certify that on the 21ST day of April, 1923, I found evidence of the Section corner of 11, 12, 13 & 14 Township 33, North, Range 12E, Fourth, Principal Meridian, as described hereon; and that from this evidence I established a new monument and accessories as described hereon to perpetuate the original location of this corner.

History of original corner establishment:

1 1/4" pipe line blazed N & S



Description of corner evidence found:

Resident witnesses:

.....
.....
.....

Description of monument and accessories I established to perpetuate the original location of this corner.

Set 2" pipe with brass cap MARKED
New BT's
Hard Maple 6" S32E 15.6 FT
Hard Maple 5" S60W 30.3 FT

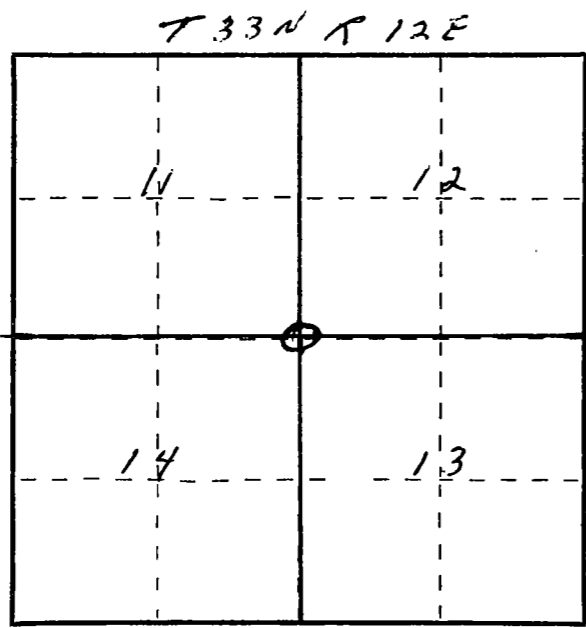

○ = Corner monument restored.

Dated at Antigo, Wis., this 21ST day of April, 1923.

Signature Raymond Hallist Title Reg. Land Surveyor Registration No. 5-685
(County Surveyor, Registered Land Surveyor, or other duly authorized official)

Office of Register of Deeds, County of, I hereby certify that the within instrument was filed in this office for record on the..... day of....., 19..... at..... o'clock..... M.

.....
(Register of Deeds)

By..... Deputy

FORM 985 H. C. MILLER CO., MILWAUKEE