

CERTIFIED LAND CORNER RESTORATION

33-12
Index No. J-12

State of Wisconsin }
County of Langlade } ss.

I, Robert J. Poss, do hereby certify that on the 22nd day of May, 19 68, I found evidence of the East 1/4 corner of Sections 9 & 16 Township 33, North, Range 12 East, Fourth, Principal Meridian, as described hereon; and that from this evidence I established a new monument and accessories as described hereon to perpetuate the original location of this corner.

Resident witnesses:

.....
.....
.....

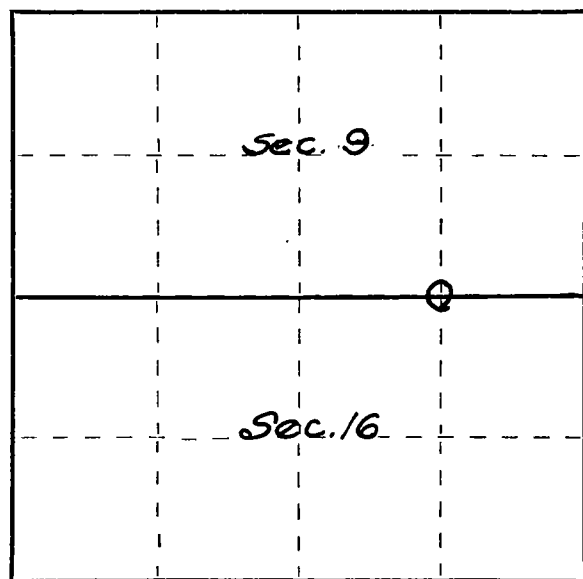

○ = Corner monument restored.

History of original corner establishment:

Description of corner evidence found:

Found Old stake split but o.k. surrounded by "hard heads". I.Pipe with brass cap set by Sprague of Wis.Pwr. & Lt. flush with ground in ctr. split stake

Description of monument and accessories I established to perpetuate the original location of this corner.

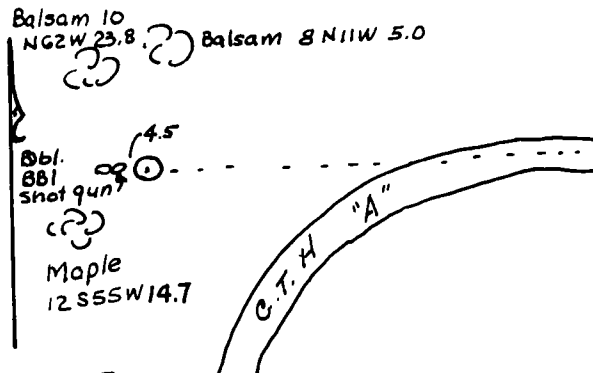

Dated at Elcho, Wis., this 23rd day of May, 19 68.

Signature Robert J. Poss Title Reg. Land Surveyor Registration No. 5-1
(County Surveyor, Registered Land Surveyor, or other duly authorized official)

Office of Register of Deeds, County of....., I hereby certify that the within instrument was filed in this office for record on the..... day of....., 19..... at..... o'clock..... M.

.....
(Register of Deeds)

By..... Deputy

