

CERTIFIED LAND CORNER RESTORATION

33-12

Index No. E-25

State of Wisconsin }  
County of L ANGLADE } ss.

History of original corner establishment:

I THOMAS R. ARNOTT, do hereby certify that on the 19<sup>TH</sup> day of MAY, 1973, I found evidence of the SECTION corner of SECS. 1, 12, 6 & 7 Township 33 North, Range 12 & 13 EAST, Fourth Principal Meridian, as described hereon; and that from this evidence I established a new monument and accessories as described hereon to perpetuate the original location of this corner.

Description of corner evidence found:

Resident witnesses:

Description of monument and accessories I established to perpetuate the original location of this corner.

SET 2" IRON PIPE W/BRASS CAP MKD

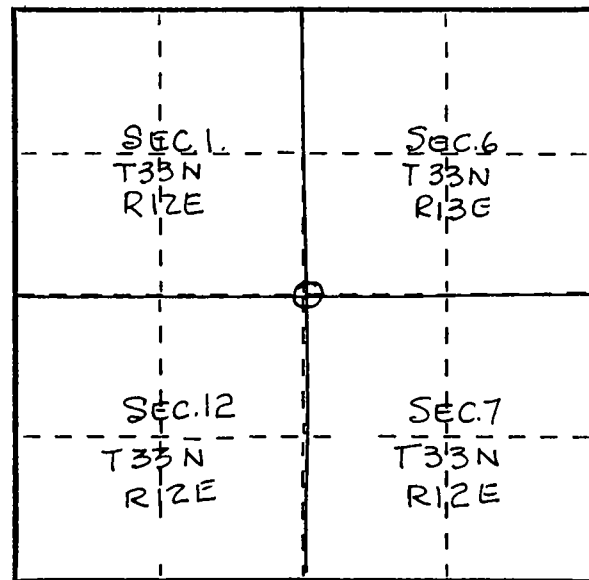

○ = Corner monument restored.

VOID 9/6/94 D.T.  
SEE NEW E-1 33-13

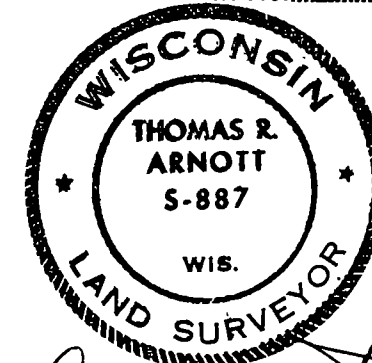

Thomas R. Arnott

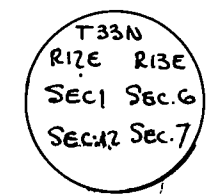
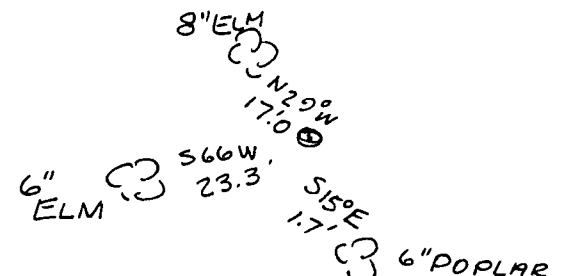

ALL TREES BLAZED & SCRIBED B.T

Dated at ANTIGO, Wis., this 13<sup>TH</sup> day of JUNE, 1973

Signature: Thomas R. Arnott Title: REG. LAND SURVEYOR Registration No. 5887  
(County Surveyor, Registered Land Surveyor, or other duly authorized official)

Office of Register of Deeds, County of \_\_\_\_\_, I hereby certify that the within instrument was filed in this office for record on the \_\_\_\_\_ day of \_\_\_\_\_, 19\_\_\_\_ at \_\_\_\_\_ o'clock \_\_\_\_\_ M.

\_\_\_\_\_  
(Register of Deeds)

Richard J. Ford  
County Surveyor

By \_\_\_\_\_ Deputy

FORM 985 M. C. MILLER CO., MILWAUKEE