

CERTIFIED LAND CORNER RESTORATION

Index No. X-13

State of Wisconsin }
County of Langlade } ss.

I R. J. Hallisy, do hereby certify that on the 3rd day of May, 1980, I found evidence of the 1/4 corner of Section 33 & 34 Township 33 North, Range 11E, Fourth Principal Meridian, as described hereon; and that from this evidence I established a new monument and accessories as described hereon to perpetuate the original location of this corner.

Resident witnesses:

.....
.....
.....

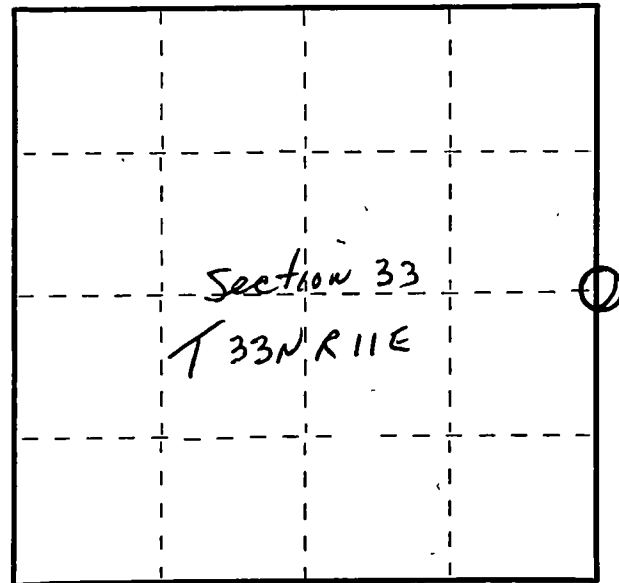

○ = Corner monument restored.

History of original corner establishment:

Corner set in the 1930 resurvey.

Description of corner evidence found:

4" iron pipe with brass cap.
8" tamarack posts scribed BT,
S56W 6'1"
N42E 5'8"

Description of monument and accessories I established to perpetuate the original location of this corner.

New BT's

5" Black Spruce N14W 4'1"
5" Black Spruce S47W 21'7"
4" Tamarack S54E 18'1"

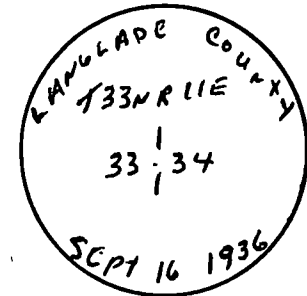

Dated at Antigo, Wis., this 3rd day of May, 1980.

Signature: *Raymond J. Hallisy* Title: Land Surveyor Registration No. S-685
(County Surveyor, Registered Land Surveyor, or other duly authorized official)

Office of Register of Deeds, County of _____, I hereby certify that the within instrument was filed in this office for record on the _____ day of _____, 19____ at _____ o'clock _____ M.

(Register of Deeds)

By _____ Deputy

FORM 985 H. C. MILLER CO., MILWAUKEE