

CERTIFIED LAND CORNER RESTORATION

Index No. ~~.....~~

A-9

State of Wisconsin }
County of LANGLADE } ss.

I WILLIAM F. KELLY, do hereby certify that on the 12th day of JAN., 1982, I found evidence of the SE corner of SECTION 32 Township 33, North, Range 11 EAST, Fourth Principal Meridian, as described hereon; and that from this evidence I established a new monument and accessories as described hereon to perpetuate the original location of this corner.

Resident witnesses:
.....
.....
.....

History of original corner establishment:

ORIGINAL CORNER ESTABLISHED BY
HIRAM C. FELLOWS IN SEPT., 1860.

Description of corner evidence found:

4" BRASS CAP MONUMENT, FOUND IN PLACE.
SET IN OCT 1936 BY
CCC ON RESURVEY
OF AREA.

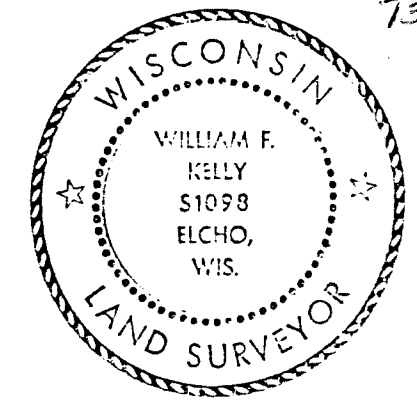

T32N-R11E

Description of monument and accessories I established to perpetuate the original location of this corner.

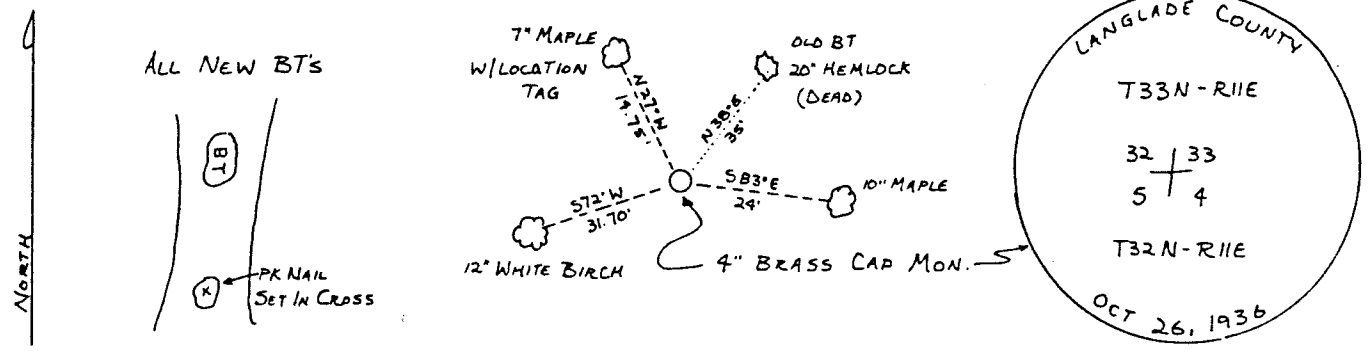

FORM 985 H. C. MILLER CO., MILWAUKEE

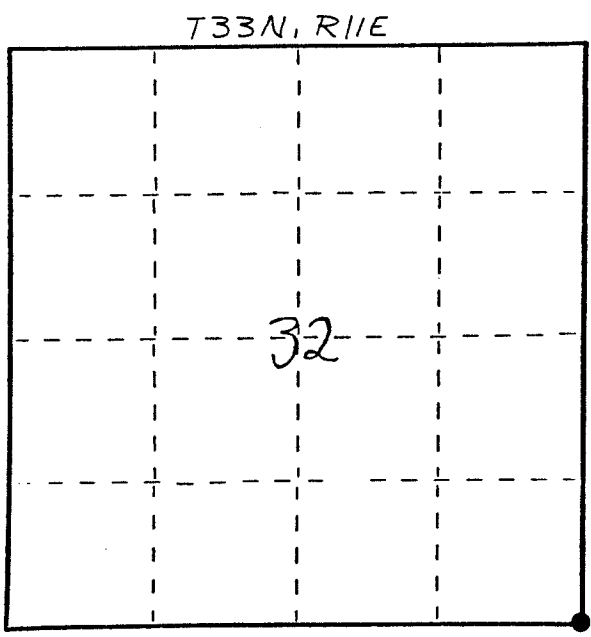

○ = Corner monument restored.

Dated at ELCHO, Wis., this 12th day of JAN., 1982.

Signature William F. Kelly Title COUNTY SURVEYOR Registration No. 1098
(County Surveyor, Registered Land Surveyor, or other duly authorized official)

Office of Register of Deeds, County of _____, I hereby certify that the within instrument was filed in this office for record on the _____ day of _____, 19____ at _____ o'clock _____ M.

.....
(Register of Deeds)

By..... Deputy