

CERTIFIED LAND CORNER RESTORATION

33-11

Index No. 0-17

State of Wisconsin }  
County of Lanai } ss.

I, Raymond J. Hallisy, do hereby certify that on the 16th day of October, 1971, I found evidence of the N 1/4 corner of Section 22 Township 33, North, Range 11E, Fourth, Principal Meridian, as described hereon; and that from this evidence I established a new monument and accessories as described hereon to perpetuate the original location of this corner.

Resident witnesses:  
\_\_\_\_\_  
\_\_\_\_\_  
\_\_\_\_\_

FORM 985 H. C. MILLER CO., MILWAUKEE

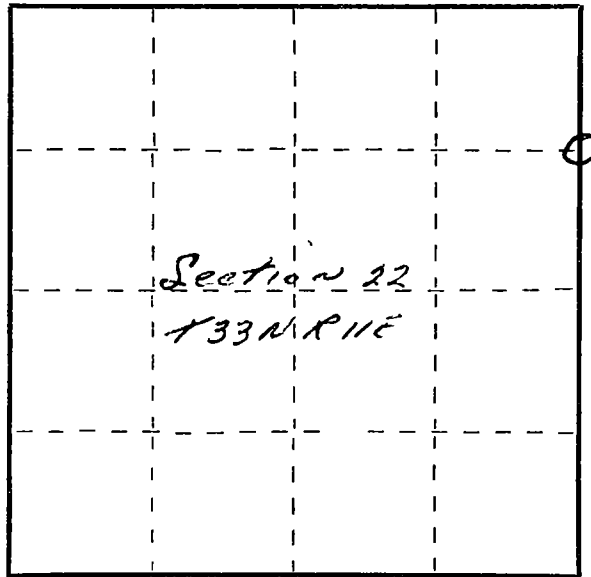

○ = Corner monument restored.

History of original corner establishment:

Corner Set in the 1930 Resurvey

Description of corner evidence found:

Found Squared Stake Standing in Rock mound MARKS NOT PLAIN

Description of monument and accessories I established to perpetuate the original location of this corner.

Set 2" pipe with brass cap

New BT's

Red maple 6" N 8E 7.1 FT

Red maple 4" N 75W 2 FT

BT's faced at base of tree and scribed BT.

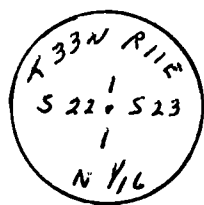

Dated at Antigo, Wis., this 16th day of October, 1971.

Signature Raymond J. Hallisy Title Reg. Land Surveyor Registration No. A-685  
(County Surveyor, Registered Land Surveyor, or other duly authorized official)

Office of Register of Deeds, County of \_\_\_\_\_, I hereby certify that the within instrument was filed in this office for record on the \_\_\_\_\_ day of \_\_\_\_\_, 19\_\_\_\_ at \_\_\_\_\_ o'clock \_\_\_\_\_ M.

\_\_\_\_\_  
(Register of Deeds)

By \_\_\_\_\_ Deputy