

CERTIFIED LAND CORNER RESTORATION

33-1)

Index No. Q-17

State of Wisconsin }
County of Langlade } ss.

I, Raymond J. Hallisy, do hereby certify that on the 22nd day of June, 19 68, I found evidence of the S 1/16 corner of Section 22 Township 33, North, Range 11, Fourth, Principal Meridian, as described hereon; and that from this evidence I established a new monument and accessories as described hereon to perpetuate the original location of this corner.

Resident witnesses:

.....
.....
.....

FORM 585 H. C. MILLER CO., MILWAUKEE

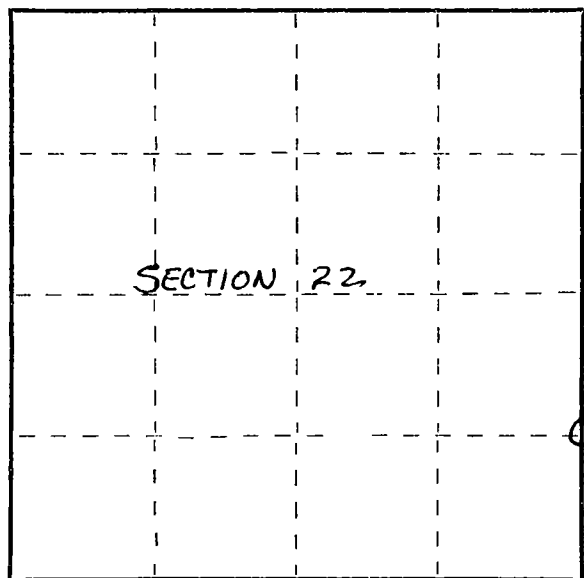

○ = Corner monument restored.

History of original corner establishment:

Corner set in the 1930's by: E. F. Kowalke
C. W. Borth

Description of corner evidence found:

Found squashed stake down, point in rock mound.
Marked S1/8 S22 S23

Description of monument and accessories I established to perpetuate the original location of this corner.

Set std. 1 1/2" pipe with cap marked S 1/16 22 23

7" ELM N40W
20' 6" →
SCRIBED BT

IP

○ 10" WHITE BIRCH S3E 4' 6"
SCRIBED BT

Dated at Antigo, Wis., this 22nd day of June, 19 68

Signature Raymond J. Hallisy Title Land Surveyor Registration No. S-685
(County Surveyor, Registered Land Surveyor, or other duly authorized official)

Office of Register of Deeds, County of _____, I hereby certify that the within instrument was filed in this office for record on the _____ day of _____, 19 _____ at _____ o'clock _____ M.

.....
(Register of Deeds)

By _____ Deputy