

CERTIFIED LAND CORNER RESTORATION

Index No. R-17

State of Wisconsin }
County of Lancaster } ss.

I, Raymond J. Hallisy, do hereby certify that on the 22nd day of September, 1984, I found evidence of the Section corner of 22, 23, 26, & 27 Township 33, North, Range 11E, Fourth Principal Meridian, as described hereon; and that from this evidence I established a new monument and accessories as described hereon to perpetuate the original location of this corner.

Resident witnesses:

.....
.....
.....

History of original corner establishment:

1930 resurvey

Description of corner evidence found:

4" iron pipe with brass cap.

Description of monument and accessories I established to perpetuate the original location of this corner.

New BT's

8" Yellow Birch S28E 3.2 ft
1 1/4" Red Maple N12W 13.3 "
12" White Birch N50W 22.3 "
1 1/4" Red Maple S20W 21.2 "

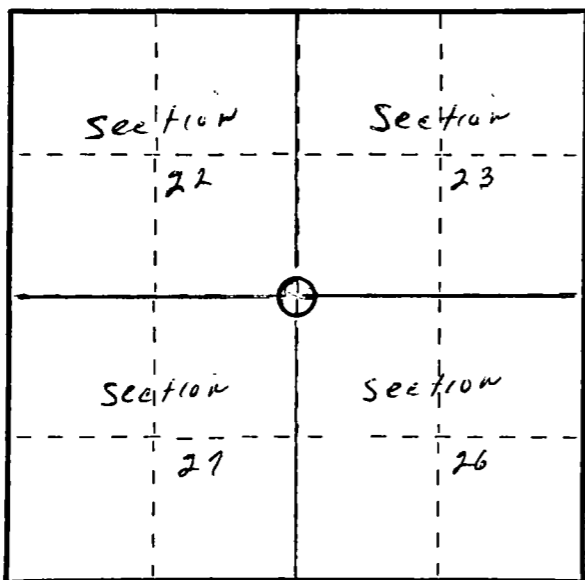
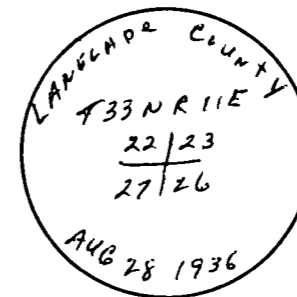

○ = Corner monument restored.

Dated at Antigo, Wis., this 22nd day of September, 1984

Signature Raymond J. Hallisy Title Land Surveyor Registration No. S-685
(County Surveyor, Registered Land Surveyor, or other duly authorized official)

Office of Register of Deeds, County of....., I hereby certify that the within instrument was filed in this office for record on the..... day of....., 19..... at..... o'clock..... M.

.....
(Register of Deeds)

By..... Deputy

FORM 985 R. C. MILLER CO., MILWAUKEE