

CERTIFIED LAND CORNER RESTORATION

Index No. M-5

State of Wisconsin }  
County of Lanola } ss.

I, Raymond Hallisy, do hereby certify that on the 27<sup>th</sup> day of April, 1974, I found evidence of the S 1/6 corner of 18 & 17 Township 33, North, Range 11E, Fourth Principal Meridian, as described hereon; and that from this evidence I established a new monument and accessories as described hereon to perpetuate the original location of this corner.

Resident witnesses:

.....  
.....  
.....

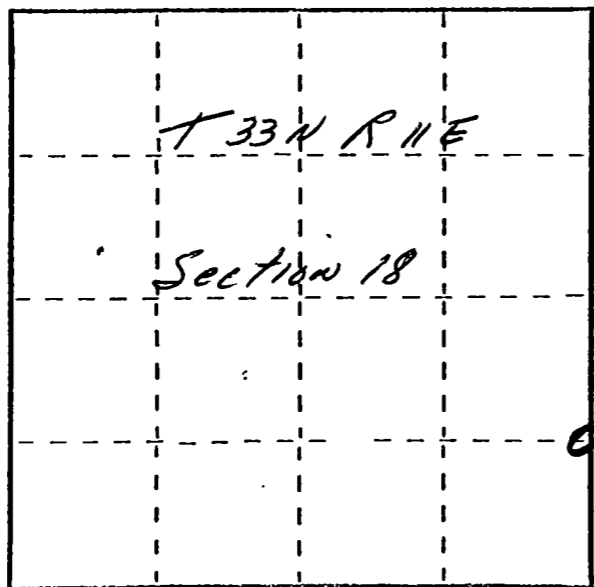

○ = Corner monument restored.

History of original corner establishment:

1930 Resurvey

Description of corner evidence found:

Wood post down, point intact  
Marked S 1/8 18, 17  
Rock mound

Description of monument and accessories I established to perpetuate the original location of this corner.

Set 1 1/2" pipe with brass cap, Rock mound

New BT's

8" Spruce N39W 10'6"

9" Tamarack S21E 40'6"

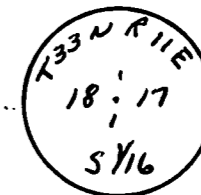

Dated at Antigo, Wis., this 27<sup>th</sup> day of April, 1974.

Signature Raymond Hallisy Title Reg. Land Surveyor Registration No. 5-685  
(County Surveyor, Registered Land Surveyor, or other duly authorized official)

Office of Register of Deeds, County of \_\_\_\_\_, I hereby certify that the within instrument was filed in this office for record on the \_\_\_\_\_ day of \_\_\_\_\_, 19\_\_\_\_ at \_\_\_\_\_ o'clock \_\_\_\_\_ M.

.....  
(Register of Deeds)

By \_\_\_\_\_ Deputy