

CERTIFIED LAND CORNER RESTORATION

Index No. L-9
33-11

State of Wisconsin }
County of Langlade } ss.

I Raymond J. Hallisy, do hereby certify that on the 27th day of November, 19 77, I found evidence of the 1/4 corner of 16 & 17 Township 33, North, Range 11E, Fourth Principal Meridian, as described hereon; and that from this evidence I established a new monument and accessories as described hereon to perpetuate the original location of this corner.

Resident witnesses:

.....
.....
.....

History of original corner establishment:

Corner set in the 1930 resurvey

Description of corner evidence found:

4" iron pipe with brass cap west of logging road.

Description of monument and accessories I established to perpetuate the original location of this corner.

New BT's to witness corner

10" Tamarack S65E 22' 4"
5" Tamarack S84E 18' 2"
5" Tamarack N40W 27'

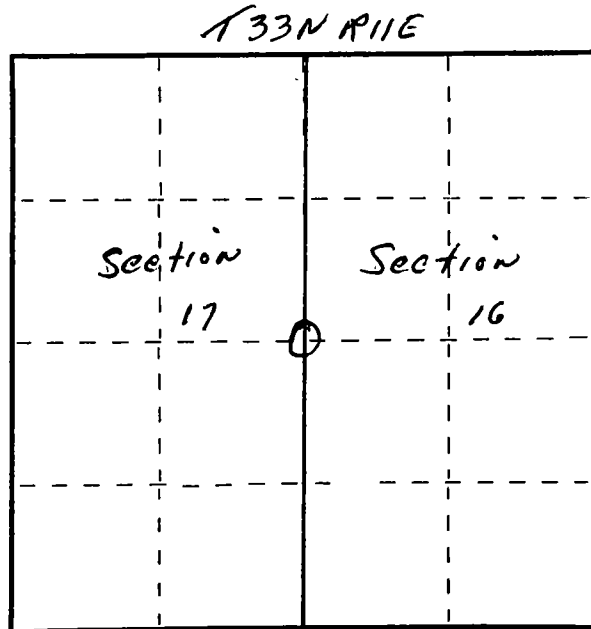
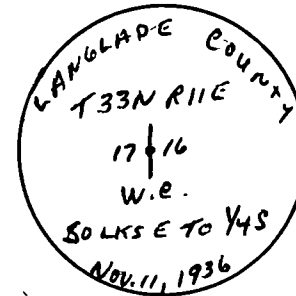

○ = Corner monument restored.

Dated at Antigo, Wis., this 27th day of November, 19 77

Signature Raymond J. Hallisy Title Land Surveyor Registration No. 5685
(County Surveyor, Registered Land Surveyor, or other duly authorized official)

Office of Register of Deeds, County of _____, I hereby certify that the within instrument was filed in this office for record on the _____ day of _____, 19 _____ at _____ o'clock _____ M.

(Register of Deeds)

By _____ Deputy

FORM 985 K C MILLER CO., MILWAUKEE