

CERTIFIED LAND CORNER RESTORATION

33-1/  
Index No. M-9

State of Wisconsin }  
County of Langlade } ss.

I, Raymond J. Hallisy, do hereby certify that on the 15th day of November, 1969, I found evidence of the S 1/16 corner of Section 16 Township T 33, North, Range 11E, Fourth, Principal Meridian, as described hereon; and that from this evidence I established a new monument and accessories as described hereon to perpetuate the original location of this corner.

Resident witnesses:

.....  
.....  
.....

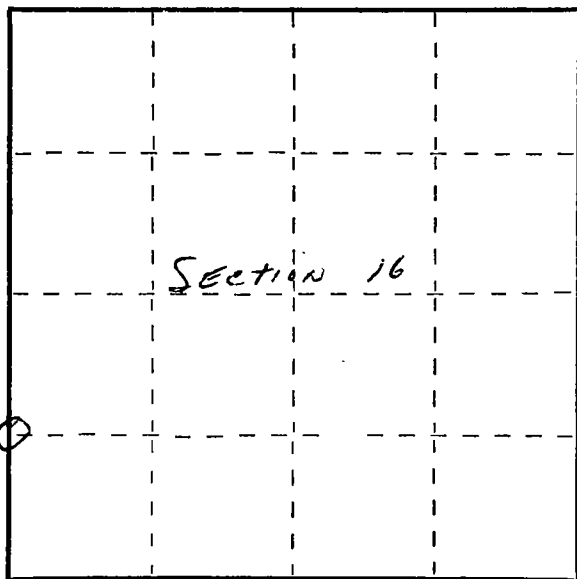

○ = Corner monument restored.

History of original corner establishment:

Corner set in the 1930 resurvey

Description of corner evidence found:

Found old stake standing, marked 16 1/8 Cor ~~16~~ 1 1/2 RDS W.

Description of monument and accessories I established to perpetuate the original location of this corner.

Set 2<sup>nd</sup> pipe with brass cap alongside post  
No B.T.'S were made as corner sets in marsh on east edge of old road. No trees near by.



Dated at Antigo, Wis., this 15th day of November, 1969

Signature Raymond J. Hallisy Title Reg. Land Surveyor Registration No. S-685  
(County Surveyor, Registered Land Surveyor, or other duly authorized official)

Office of Register of Deeds, County of \_\_\_\_\_, I hereby certify that the within instrument was filed in this office for record on the \_\_\_\_\_ day of \_\_\_\_\_, 19\_\_\_\_ at \_\_\_\_\_ o'clock \_\_\_\_\_ M.

.....  
(Register of Deeds)

By \_\_\_\_\_ Deputy