

CERTIFIED LAND CORNER RESTORATION

33-11

Index No. N-6

State of Wisconsin }
County of Langlade } ss.

I Raymond J. Hallisy, do hereby certify that on the 29th day of May, 1968, I found evidence of the W 1/16 corner of Section 20 Township 33, North, Range 11, Fourth, Principal Meridian, as described hereon; and that from this evidence I established a new monument and accessories as described hereon to perpetuate the original location of this corner.

Resident witnesses:

.....
.....
.....

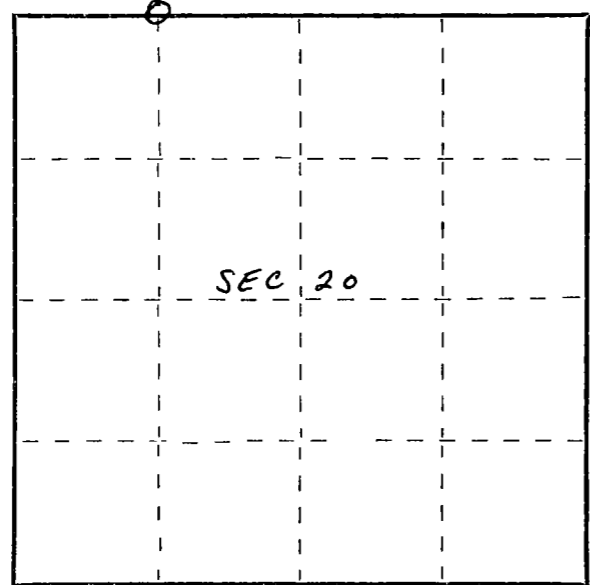

○ = Corner monument restored.

History of original corner establishment:

Corner set in the 1930's by: E. F. Kowalke
C. W. Borth

Description of corner evidence found:

Found Squared stake and rock mound.
Stake marked WC C. 1 Rd. S.

Description of monument and accessories I established to perpetuate the original location of this corner.

Set Std. 1 1/2" pipe with cap marked W 1/16 W.C. C. 1rd. S.
New BT's witness the W.C.

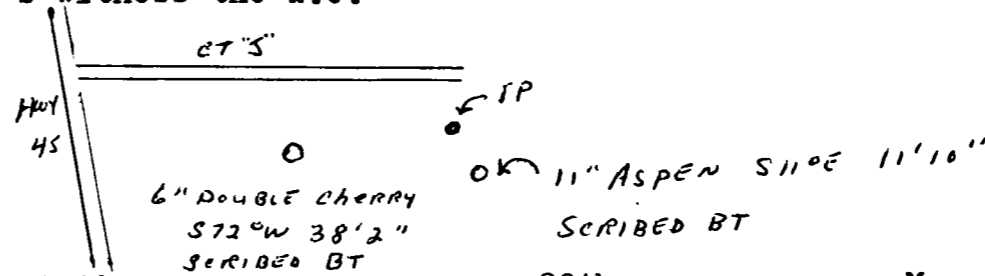

Dated at Antigo, Wis., this 29th day of May, 1968

Signature Raymond J. Hallisy Title Reg. Land Surveyor Registration No. A 685
(County Surveyor, Registered Land Surveyor, or other duly authorized official)

Office of Register of Deeds, County of _____, I hereby certify that the within instrument was filed in this office for record on the _____ day of _____, 19____ at _____ o'clock _____ M.

(Register of Deeds)

By _____ Deputy

FORM 985 H. C. MILLER CO. MILWAUKEE