

CERTIFIED LAND CORNER RESTORATION

Index No. N-13

State of Wisconsin }
County of LANGLADE } ss.

History of original corner establishment:

I RAYMOND J. HALLISY, do hereby certify that on the 28th day of MARCH, 1981, I found evidence of the SECTION corner of 15, 16, 21, 22 Township T33N R11E, North, Range 11E, Fourth Principal Meridian, as described hereon; and that from this evidence I established a new monument and accessories as described hereon to perpetuate the original location of this corner.

ESTABLISHED IN 1936 RESURVEY

Description of corner evidence found:

4" IRON PIPE WITH BRASS CAP FLUSH WITH GROUND
OLD BT,S
8" TAM STUB S88W 33.3 LKS
12" TAM STUB S15E 33. LKS

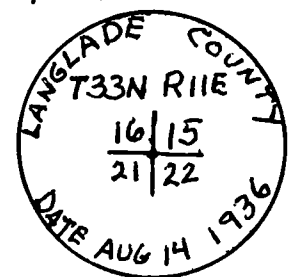

Resident witnesses:

Description of monument and accessories I established to perpetuate the original location of this corner.

NEW BT,S
4" TAM N 28 W 16 LKS
3" TAM S 38 E 27.5 LKS
9" TAM N 34 E 33 LKS

08/23/96 Dave Tlusty found monument in good condition, top of which is 1" below water surface in bog swamp. Hallisys' BT's appear to be as described, but were not checked at this time. NE tree has "No Trespassing" sign. SE tree grown shut. Set white vinyl sign post at monument. Painted all blue. Set 3/4" x 30" rebar on south shoulder of CTH "J", N 33° 47' W (geodetic) 281.20' from corner monument.

FORM 985 M. C. MILLER CO., MILWAUKEE

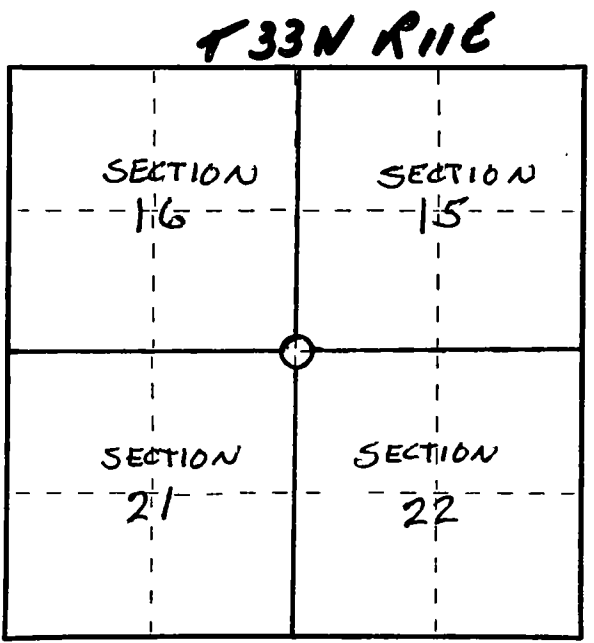

○ = Corner monument restored.

Dated at ANTIGO, Wis., this 28th day of MARCH, 1981.

Signature Raymond J. Hallisy Title Registered Land Surveyor Registration No. 5685
(County Surveyor, Registered Land Surveyor, or other duly authorized official)

Office of Register of Deeds, County of _____, I hereby certify that the within instrument was filed in this office for record on the _____ day of _____, 19____ at _____ o'clock _____ M.

(Register of Deeds)

By _____ Deputy