

CERTIFIED LAND CORNER RESTORATION

93-11

Index No. N-16

State of Wisconsin }
County of Langlade } ss.

History of original corner establishment:

Corner set in the 1930's by: E. F. Kowalke
C. W. Borth

I, Raymond J. Hallisy, do hereby certify that on the 22nd day of June, 1968, I found evidence of the E 1/16 corner of Section 15 Township 33, North, Range 11, Fourth, Principal Meridian, as described hereon; and that from this evidence I established a new monument and accessories as described hereon to perpetuate the original location of this corner.

Description of corner evidence found:

Found ~~squarred~~ stake down, rock mound and point intact.

Resident witnesses:

.....
.....
.....

Description of monument and accessories I established to perpetuate the original location of this corner.

Set std. 1 1/2" pipe with cap marked W.C. C. 50 LKS S. 15 22
Rock mount, BT'S witness the witness corner

6" RED PINE NO 43'6" → ○
SCRIBED BT

● IP _____ PENCE LAKE ROAD

○ ← 18" HARD MAPLE S 0° 61'
SCRIBED BT

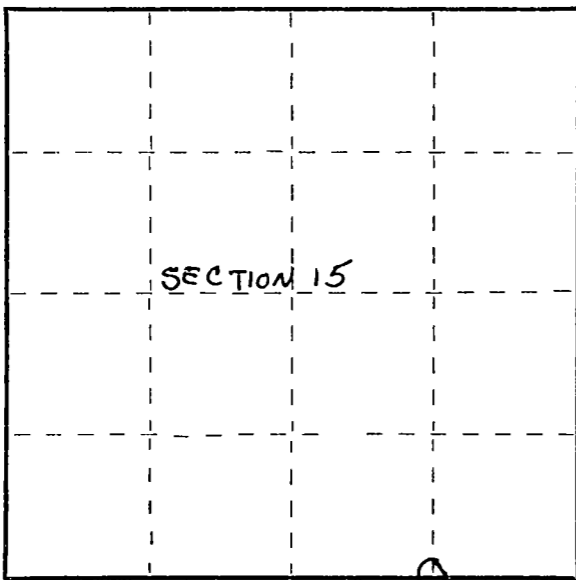

○ = Corner monument restored.

Dated at Antigo, Wis., this 22nd day of June, 1968

Signature: Raymond J. Hallisy Title: Land Surveyor Registration No. 8-685
(County Surveyor, Registered Land Surveyor, or other duly authorized official)

Office of Register of Deeds, County of _____, I hereby certify that the within instrument was filed in this office for record on the _____ day of _____, 19____ at _____ o'clock _____ M.

.....
(Register of Deeds)

By..... Deputy

FORM 935 H. C. MILLER CO., MILWAUKEE