

CERTIFIED LAND CORNER RESTORATION

Index No. N. 1
33-12

State of Wisconsin }
County of Kenosha } ss.

I Raymond J. Halliday do hereby certify that on the 22nd day of July, 1979, I found evidence of the Section corner of 13, 24, 18, & 19 Township 33, North, Range 11E & 12E, Fourth Principal Meridian, as described hereon; and that from this evidence I established a new monument and accessories as described hereon to perpetuate the original location of this corner.

Resident witnesses:

.....

.....

.....

History of original corner establishment:

Corner set in the 1930 resurvey.

Description of corner evidence found:

1/2" pipe with brass cap
1 1/2" X 1 1/2" Stone with X "66" 7' 11"
6" Y 10" Stone with X "52" 7' 7"

Description of monument and accessories I established to perpetuate the original location of this corner.

New P's

11" Aspen "55" 9' 2" with location poster
7" Red Maple "16" 17' 7"
8" Basswood "82" 29' 5"
6" Aspen "31" 1' 4"

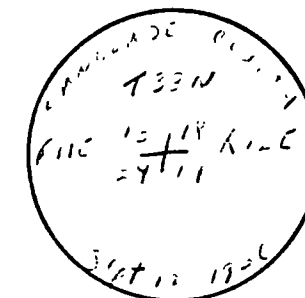

FORM 985 M. C. MILLER CO., MILWAUKEE

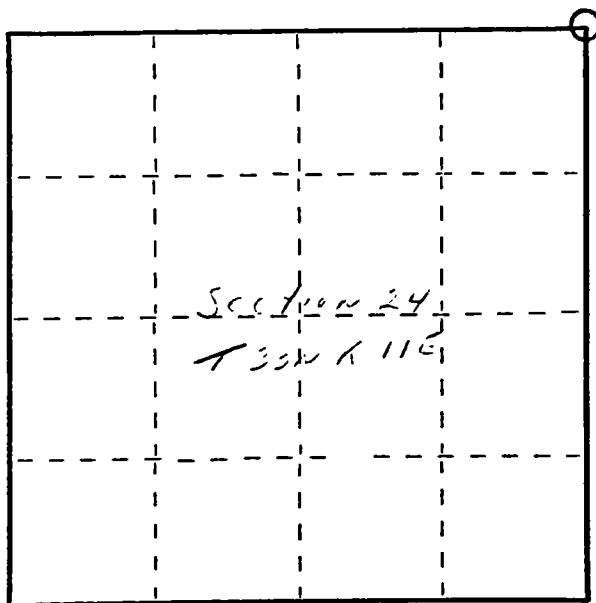

○ = Corner monument restored.

Dated at Antio, Wis., this 22nd day of July, 1979.

Signature Raymond J. Halliday Title Dep. Surveyor Registration No. 5685
(County Surveyor, Registered Land Surveyor, or other duly authorized official)

Office of Register of Deeds, County of Kenosha, I hereby certify that the within instrument was filed in this office for record on the 22nd day of July, 1979 at 10 o'clock AM.

.....
(Register of Deeds)

By.....Deputy