

CERTIFIED LAND CORNER RESTORATION

Index No. G-13

State of Wisconsin }
County of Langlade } ss.

I, Raymond J. Hallisy, do hereby certify that on the 10th day of April, 1982, I found evidence of the 1/4 corner of Section 9 & 10 Township 33, North, Range 11E, Fourth Principal Meridian, as described hereon; and that from this evidence I established a new monument and accessories as described hereon to perpetuate the original location of this corner.

Resident witnesses:

.....
.....
.....

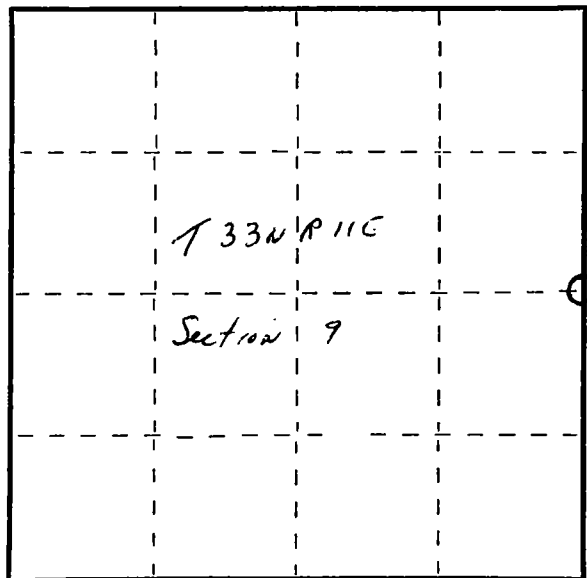

○ = Corner monument restored.

History of original corner establishment:

Corner set in the 1930 resurvey.

Description of corner evidence found:

4" iron pipe with brass cap.

Description of monument and accessories I established to perpetuate the original location of this corner.

New BT's

10" Balsam N74W 12.9'
16" Twin Oak S10E 31.3'
10" Clump Maple S64E 21.2'

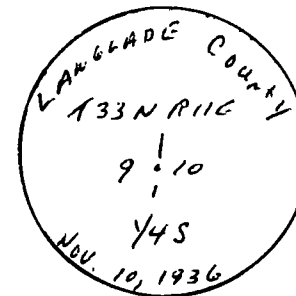

Dated at Antigo, Wis., this 10th day of April, 1982

Signature Raymond J. Hallisy Title Land Surveyor Registration No. S-685
(County Surveyor, Registered Land Surveyor, or other duly authorized official)

Office of Register of Deeds, County of, I hereby certify that the within instrument was filed in this office for record on the day of, 19..... at o'clock M.

.....
(Register of Deeds)

By Deputy