

CERTIFIED LAND CORNER RESTORATION

33-11

Index No. D-9

State of Wisconsin }  
County of Langlade } ss.

I, Raymond J. Hallisy, do hereby certify that on the 11th day of June, 1968, I found evidence of the S 1/16 corner of Section 5 Township 33, North, Range 11, Fourth, Principal Meridian, as described hereon; and that from this evidence I established a new monument and accessories as described hereon to perpetuate the original location of this corner.

Resident witnesses:  
.....  
.....  
.....

FORM 985 H. S. MILLER CO., MILWAUKEE

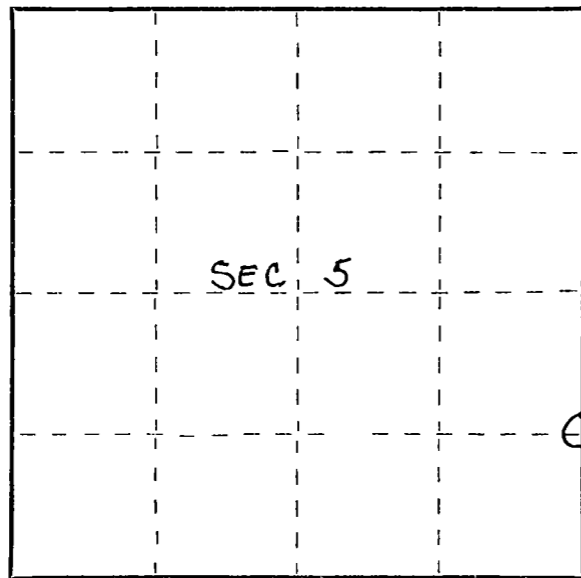

○ = Corner monument restored.

History of original corner establishment:

Corner set in the 1930's by: C. W. Borth  
E. F. Kowalke

Description of corner evidence found:

**Found squared stake and rock mound, Fence south and east.  
Marked 1/8 S5 S4**

Description of monument and accessories I established to perpetuate the original location of this corner.

**Set Std. 1 1/2" Pipe with cap marked 5 4 S 1/16**

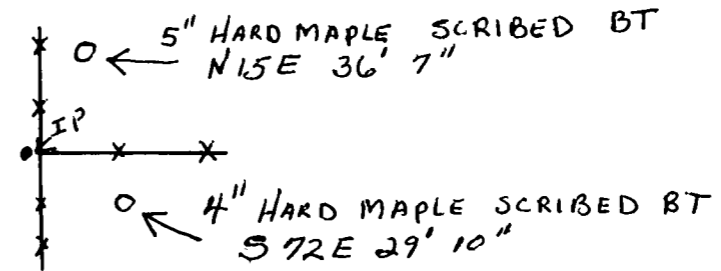

Dated at Antigo, Wis., this 11th day of June, 1968

Signature Raymond J. Hallisy Title Reg. Land Surveyor Registration No. 5-685  
(County Surveyor, Registered Land Surveyor, or other duly authorized official)

Office of Register of Deeds, County of \_\_\_\_\_, I hereby certify that the within instrument was filed in this office for record on the \_\_\_\_\_ day of \_\_\_\_\_, 19\_\_\_\_ at \_\_\_\_\_ o'clock \_\_\_\_\_ M.

(Register of Deeds)

By \_\_\_\_\_ Deputy