

U. S. PUBLIC LAND SURVEY MONUMENT RECORD

INSTRUCTIONS: This record shall show the location of the corner and shall include all of the following nine elements (a through i).

- (a) Identify the corner by reference to the U.S. public land survey system.
 ○ = Corner monument restored.

T33N R11E
 SECTION 8
 E¹/₁₆ CORNER BETWEEN
 SECTIONS $\frac{5}{8}$

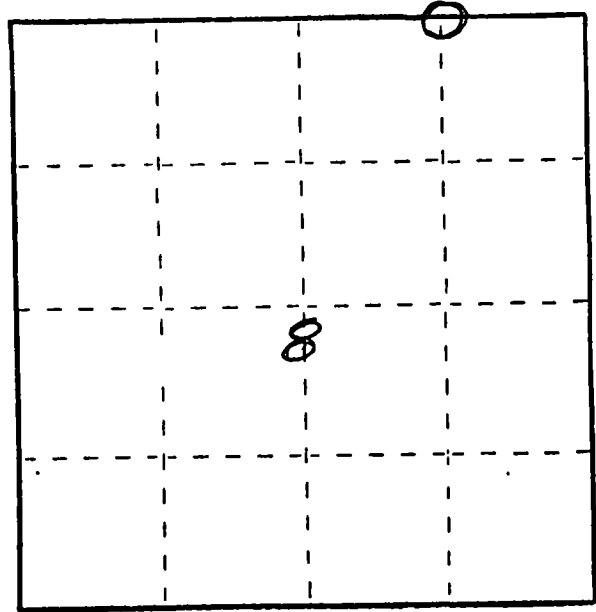

- (b) Describe any record evidence, monument evidence, occupational evidence, testimonial evidence or any other material evidence you considered, and whether the monument was found or placed.

1. RESTORED MAY 11, 1969 - TOWNSHIP INDEX NO. E-8
2. WOOD POST - POINT ONLY
3. 2" IRON PIPE WITH BRASS CAP - FROST HEAVE - WOOD POST IN PLACE
4. B.T.'S CUT
5. NEW B.T.'S SCRIBED AT BASE OF TREES.

- (c) In the plan view drawing below, provide reference ties to at least 4 witness monuments, or, if the location is within a municipality, to at least 2 witness monuments. (Witness monuments shall be made of concrete, natural stone, iron or other equally durable material.) Describe witness monuments.

- (d) Show a plan view drawing depicting the relevant monuments and reference ties which is sufficient in detail to enable accurate relocation of the corner monument if the corner monument is disturbed. Indicate north.

RESET POST PLUS ROCK MOUND
 ON NORTH SIDE Co. Hwy "T"

3- NEW B.T.S - BEARING TREES
(B.T.) TO WITNESS CORNER

- 1) RED MAPLE - 12" - N4°E - 35.66 FEET
- 2) WH. BIRCH - 16" - N62°E - 83.83 FEET
- 3) HARD MAPLE - 12" - N70°W - 73.33 FEET

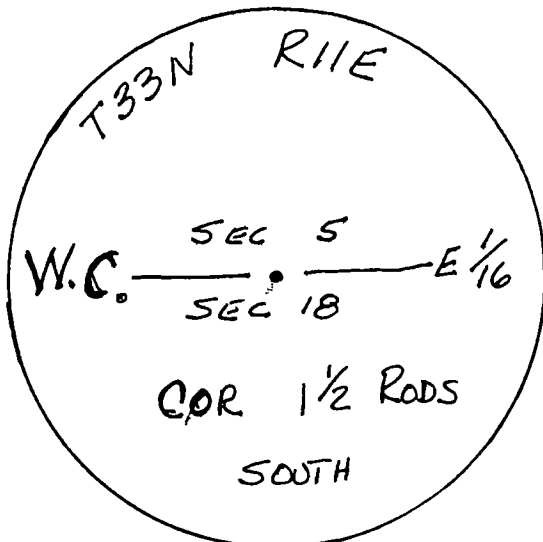

REMOVE OLD CERTIFIED
CORNER SHEET - E-8
T33N R11E

(e) Describe any material discrepancy between the location of the corner as restored or reestablished and the location of that corner as previously restored or reestablished by distance and direction. Show the discrepancy on the plan view drawing under (d), above. Show the distances between the corner as previously restored or reestablished and (1) the corner as restored or reestablished, and (2) to at least 2 of the witness monuments shown on the drawing in (d), above.

N. A. ~~_____~~

(f) Was the corner restored through acceptance of (1) an obliterated evidence location, or, (2) a found perpetuated location?

2

(g&h) Was the corner reestablished through lost corner proportionate methods? If so, show the method, including the directions and distances to other public land survey corners used as evidence or used for proportioning in determining the corner location?

N. A.

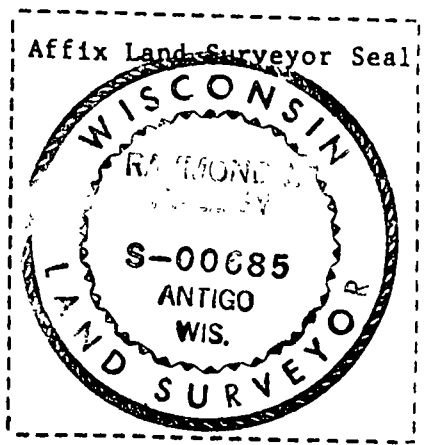

(1) I, RAYMOND J. HALLISY - (G. WEIX - WITNESS)
(Type or print name) certify that the corner location shown on this record was determined by me or under my direction and control and that this U.S. Public Land Survey Monument Record is correct and complete to the best of my knowledge and belief.

Raymond J. Hallisy
Signature

5-3-91
Date

CERTIFIED LAND CORNER RESTORATION

33-11

Index No. E-8

State of Wisconsin }
County of Langlade } ss.

I Raymond J. Hallist, do hereby certify that on the 11th day of May, 19 69, I found evidence of the E 1/16 corner of Section 8 Township 33, North, Range 11E, Fourth, Principal Meridian, as described hereon; and that from this evidence I established a new monument and accessories as described hereon to perpetuate the original location of this corner.

History of original corner establishment:

Corner set in the 1930 resurvey.

Description of corner evidence found:

Found old stake standing, marked 1/8 Cor 1 1/2 RDS S

Resident witnesses:

.....
.....
.....

Description of monument and accessories I established to perpetuate the original location of this corner.

Set 2" pipe with brass cap north of road as witness corner.

B.T.'s to witness corner

Oak 12" N28W 66Ft. 6 inches

Oak 14" N6W 63Ft. 5 inches

B.T.'s faced at base of tree and scribed BT

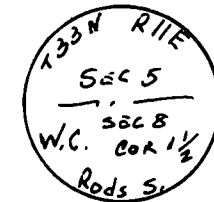

BRASS CAP MARKED

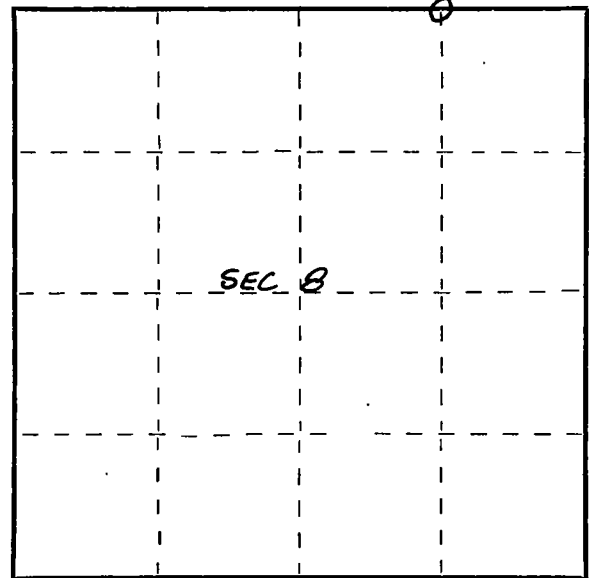

○ = Corner monument restored.

Dated at Antigo, Wis., this 11th day of May, 19 69.

Signature Raymond J. Hallist Title Reg. Land Surveyor Registration No. S-685
(County Surveyor, Registered Land Surveyor, or other duly authorized official)

Office of Register of Deeds, County of....., I hereby certify that the within instrument was filed in this office for record on the..... day of....., 19..... at..... o'clock..... M.

(Register of Deeds)

By..... Deputy

FORM 985 M. C. MILLER CO., MILWAUKEE