

CERTIFIED LAND CORNER RESTORATION

Index No. E-13

State of Wisconsin }
 County of Langlade } ss.

I Raymond Hallisy, do hereby certify that on the 27th day of June, 1987, I found evidence of the Section corner of 3, 4, 9, 10 Township 33N, North, Range 11E, Fourth Principal Meridian, as described hereon; and that from this evidence I established a new monument and accessories as described hereon to perpetuate the original location of this corner.

Resident witnesses:

.....

FORM 985 M. C. MILLER CO., MILWAUKEE

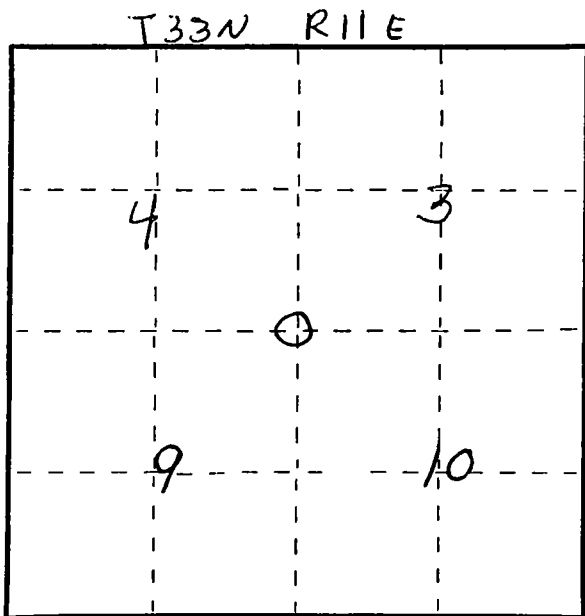

○ = Corner monument restored.

History of original corner establishment:

Corner set in 1930, Resurvey

Description of corner evidence found:

4" Pipe with Brass cap

white pine BT
wind thrown

other BTs Destroyed
by construction crew

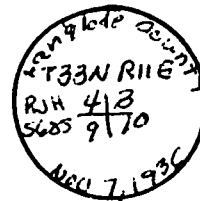

Description of monument and accessories I established to perpetuate the original location of this corner.

New BTs

<u>Hard maple</u>	<u>10"</u>	<u>S48W</u>	<u>193.6</u>	<u>LKS</u>
<u>IRONWOOD</u>	<u>5"</u>	<u>S52W</u>	<u>189.2</u>	<u>LKS</u>
<u>Hard maple</u>	<u>7"</u>	<u>S54W</u>	<u>182</u>	<u>LKS</u>
<u>Red OAK</u>	<u>7"</u>	<u>N56E</u>	<u>133.5</u>	<u>LKS</u>

Dated at Antigo, Wis., this 27th day of June, 1987.

Signature Raymond Hallisy Title Land Surveyor Registration No. 5-685
 (County Surveyor, Registered Land Surveyor, or other duly authorized official)

Office of Register of Deeds, County of, I hereby certify that the within instrument was filed in this office for record on the day of, 19..... at o'clock..... M.

.....
 (Register of Deeds)

By Deputy

CERTIFIED LAND CORNER RESTORATION

Index No. E-13

State of Wisconsin }
County of Langlade } ss.

I Raymond J. Hallisy, do hereby certify that on the 20th day of August, 19 77, I found evidence of the Section corner of 3, 4, 9 & 10 Township 33, North, Range 11E, Fourth Principal Meridian, as described hereon; and that from this evidence I established a new monument and accessories as described hereon to perpetuate the original location of this corner.

Resident witnesses:

.....
.....
.....

History of original corner establishment.

Corner set in the 1930 resurvey.

Description of corner evidence found:

4" iron pipe with brass cap.
Corner sets in a little swamp just north of a game opening and about 75 feet north of an old firelane.

Description of monument and accessories I established to perpetuate the original location of this corner.

New B T 's

12" White Pine S63E 18.5 Feet
8" clumped Red Maple S38E 72 Feet
8" White Birch S28E 78.4 Feet

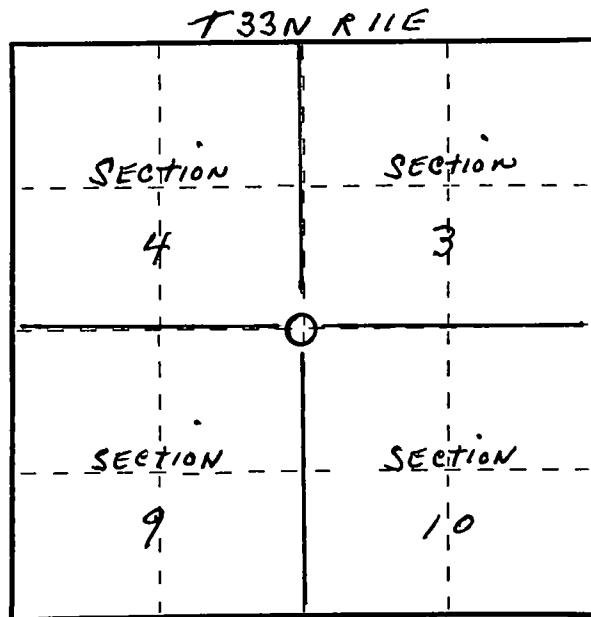
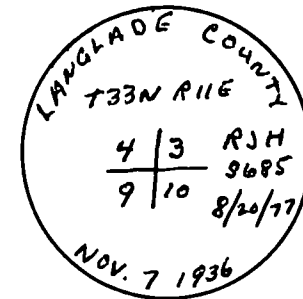

O = Corner monument restored.

Dated at Antigo, Wis., this 20th day of August, 19 77.

Signature Raymond J. Hallisy Title Land Surveyor Registration No. 5685
(County Surveyor, Registered Land Surveyor, or other duly authorized official)

Office of Register of Deeds, County of....., I hereby certify that the within instrument was filed in this office for record on the..... day of....., 19..... at..... o'clock..... M.

.....
(Register of Deeds)

By..... Deputy

FORM 985 H C MILLER CO., MILWAUKEE