

CERTIFIED LAND CORNER RESTORATION

Index No. V-W-21

State of Wisconsin }
County of Langlade } ss.

I Raymond J. Hallisy, do hereby certify that on the 3rd day of June, 19 78, I found evidence of the M.C. corner of 35 & 36 Township 33, North, Range 10E, Fourth Principal Meridian, as described hereon; and that from this evidence I established a new monument and accessories as described hereon to perpetuate the original location of this corner.

Resident witnesses:

.....
.....
.....

FORM 985 M. C. MILLER CO., MILWAUKEE

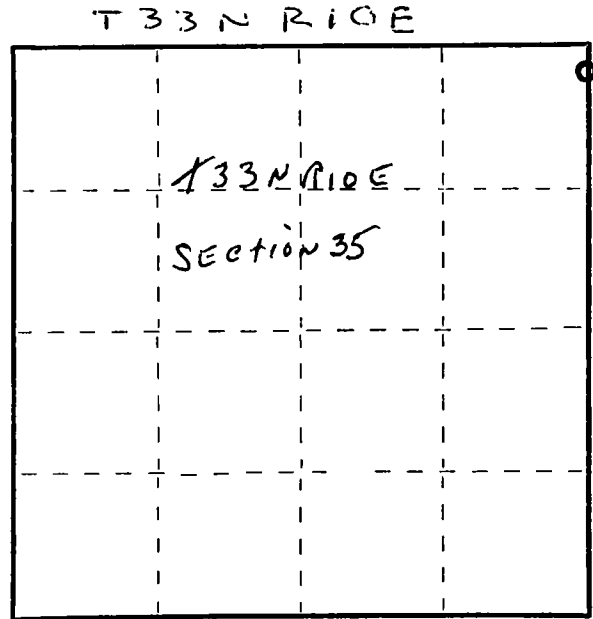

○ = Corner monument restored.

History of original corner establishment:

Established in the Dependent Resurvey and extension Survey in 1931, of Sections 26, 35, & 36.

Description of corner evidence found:

2" pipe with brass cap.
This corner sets 1.50 chains S5.07W of Section Corner to 25, 26, 35, & 36

Description of monument and accessories I established to perpetuate the original location of this corner.

New BT's

Hemlock 6" N53W 8' 3"
Red Maple 4" S25W 11' 5"
Yellow Birch 12" S56F 11' 1"

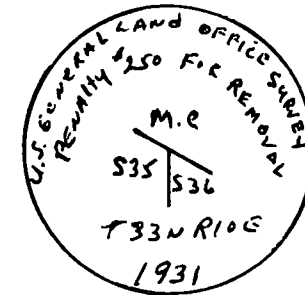

Dated at Antigo, Wis., this 3rd day of June, 19 78.

Signature Raymond J. Hallisy Title Land Surveyor Registration No. S-685
(County Surveyor, Registered Land Surveyor, or other duly authorized official)

Office of Register of Deeds, County of....., I hereby certify that the within instrument was filed in this office for record on the..... day of....., 19..... at..... o'clock..... M.

(Register of Deeds)

By..... Deputy