

CERTIFIED LAND CORNER RESTORATION

Index No. 4-12

State of Wisconsin }
County of LANGLADE } ss.

I William F. Kelly, do hereby certify that on the 6th day of MARCH, 1980, I found evidence of the SE 1/16 corner of SECT 33 Township 33, North, Range 10 EAST, Fourth Principal Meridian, as described hereon; and that from this evidence I established a new monument and accessories as described hereon to perpetuate the original location of this corner.

Resident witnesses:

History of original corner establishment:
No evidence of the corner establishment is available

Description of corner evidence found:
Corner established at the intersection of the E-W and N-S lines of the SE 1/4 Sect 33 T33N R10E.

Set 1 1/2" I.P. with Brass Cap and Marked with witness Trees



William F. Kelly

Description of monument and accessories I established to perpetuate the original location of this corner.

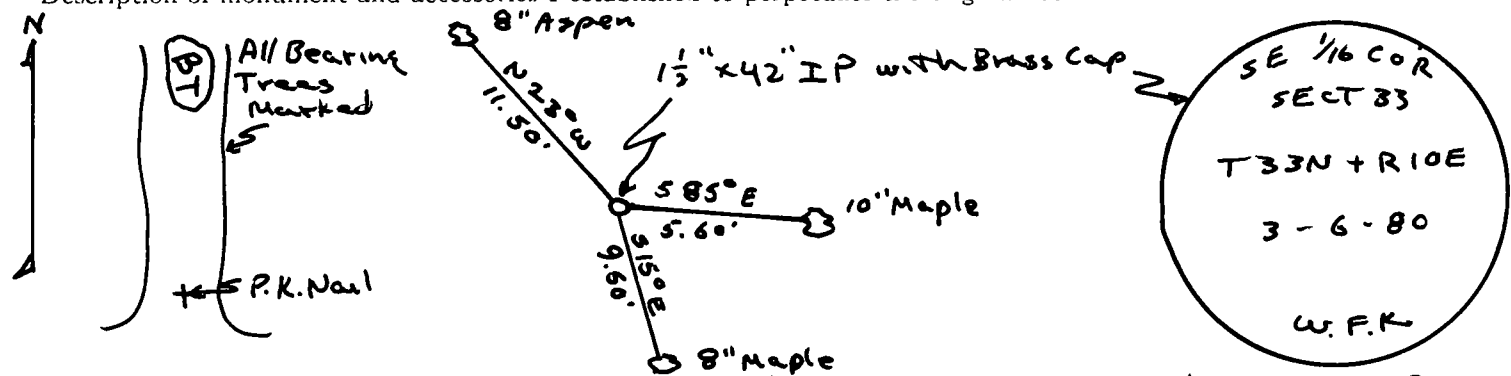

FORM 985 H. C. MILLER CO., MILWAUKEE

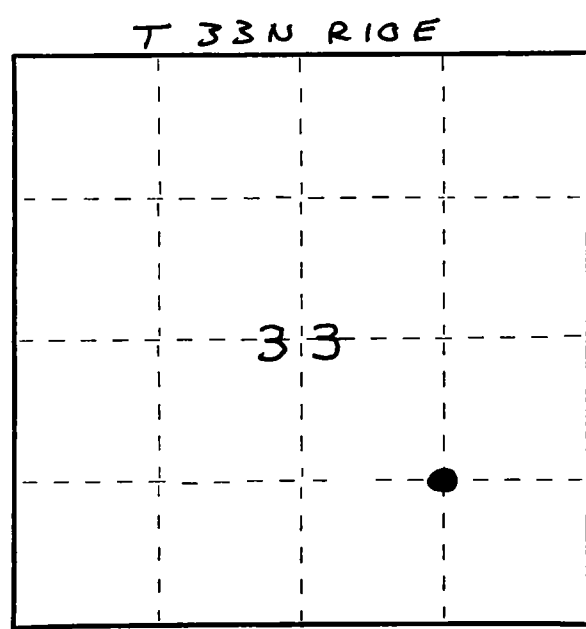

○ = Corner monument restored.

Dated at ELCHO, Wis., this 15th day of MARCH, 1980.

Signature William F. Kelly Title County Surveyor Registration No. S-1098
(County Surveyor, Registered Land Surveyor, or other duly authorized official)

Office of Register of Deeds, County of _____, I hereby certify that the within instrument was filed in this office for record on the _____ day of _____, 19____ at _____ o'clock _____ M.

(Register of Deeds)

By _____ Deputy