

CERTIFIED LAND CORNER RESTORATION

Index No. A-13

State of Wisconsin }  
 County of LANGLADE } ss.

I WILLIAM F. KELLY, do hereby certify that on the 15 day of DECEMBER, 1982, I found evidence of the SE corner of SECT. 33 Township 33, North, Range 10 EAST, Fourth Principal Meridian, as described hereon; and that from this evidence I established a new monument and accessories as described hereon to perpetuate the original location of this corner.

Resident witnesses:

R. HESS

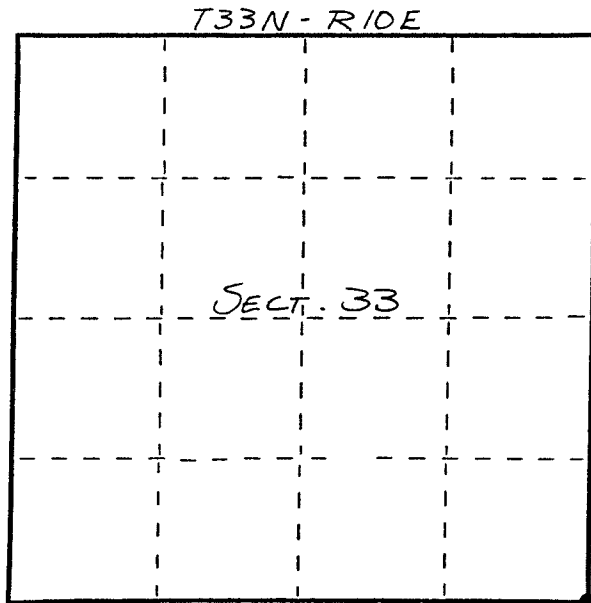

○ = Corner monument restored.

History of original corner establishment:

ORIGINAL CORNER ESTABLISHED BY  
 HIRAM C. FELLOWS IN OCT., 1860.

32-10

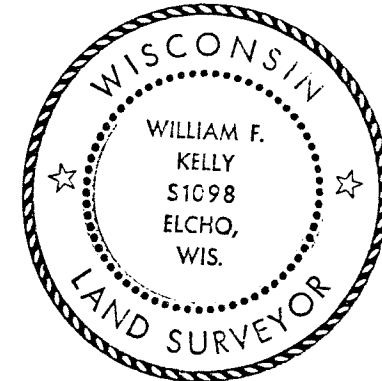

William F. Kelly  
 12-17-82

Description of corner evidence found:

SET R.R. SPIKE OVER EXISTING  
 IRON IN ROAD. SET 3" x 42"  
 ALUMINUM CAP WITNESS MONUMENT.  
 MARKED 2 NEW BT'S.

Description of monument and accessories I established to perpetuate the original location of this corner.

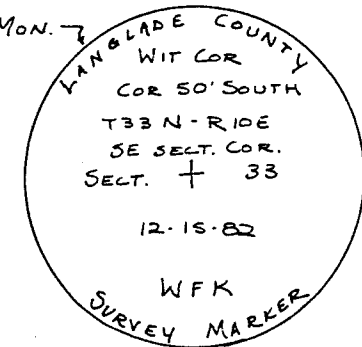
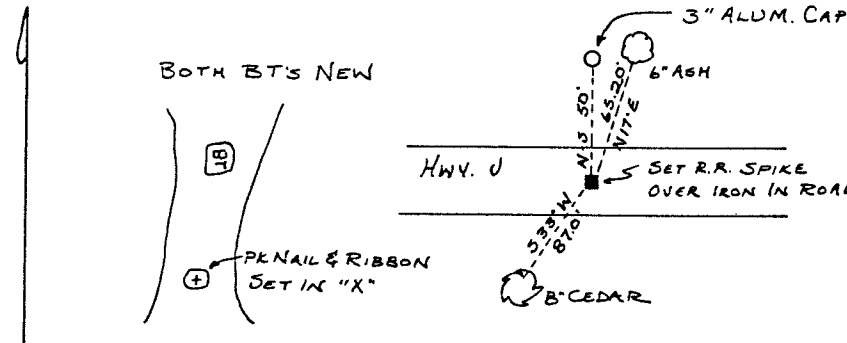

Dated at ELCHO, Wis., this 15<sup>th</sup> day of DECEMBER, 1982

Signature William F. Kelly Title COUNTY SURVEYOR Registration No. 1098  
 (County Surveyor, Registered Land Surveyor, or other duly authorized official)

Office of Register of Deeds, County of \_\_\_\_\_, I hereby certify that the within instrument was filed in this office for record on the \_\_\_\_\_ day of \_\_\_\_\_, 19\_\_\_\_ at \_\_\_\_\_ o'clock \_\_\_\_\_ M.

(Register of Deeds)

By \_\_\_\_\_ Deputy