

CERTIFIED LAND CORNER RESTORATION

Index No. X-9

State of Wisconsin }  
 County of LANGLADE } ss.

I, William F. Kelly, do hereby certify that on the 20<sup>th</sup> day of February, 1980, I found evidence of the 1/4 SECT corner of SECT 32 & 33 Township 33, North, Range 10 EAST, Fourth Principal Meridian, as described hereon; and that from this evidence I established a new monument and accessories as described hereon to perpetuate the original location of this corner.

Resident witnesses:

History of original corner establishment:  
Original corner set by Hiram Fellows in Oct 1860

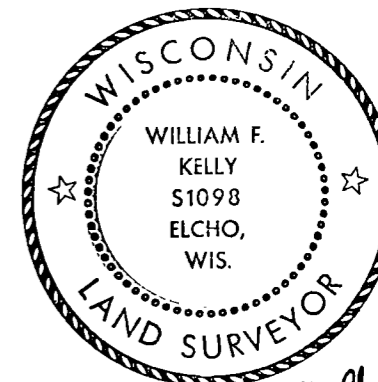

*William F. Kelly*

Description of corner evidence found:  
Located 4x4 cedar post and bearing tree called for in R. Hallisey's notes

set 2"x42" B.I.P. with brass cap and marked witness trees. set 4x4 post north of cap  
Note: corner is located in a Black Ash and spruce swamp area.

Description of monument and accessories I established to perpetuate the original location of this corner.

FORM 985 H. C. MILLER CO., MILWAUKEE

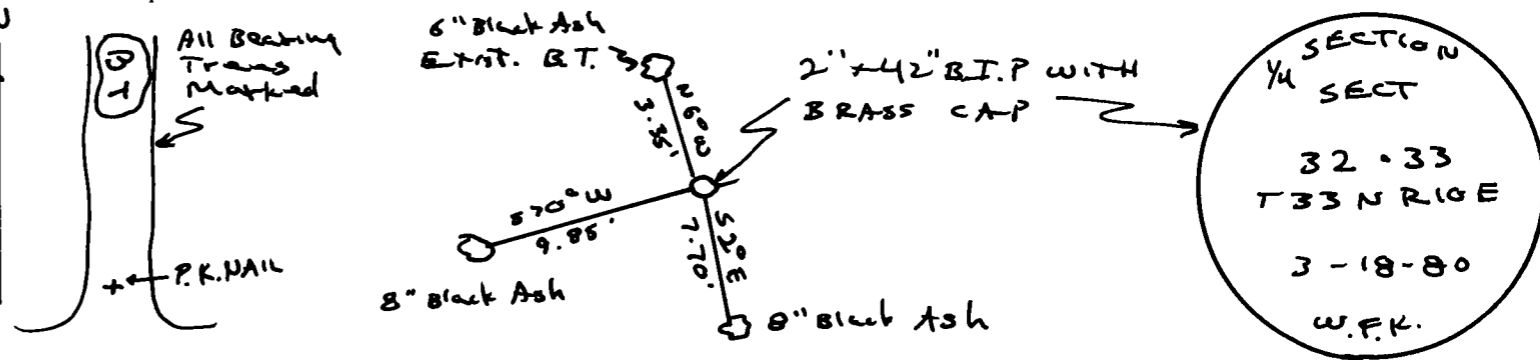
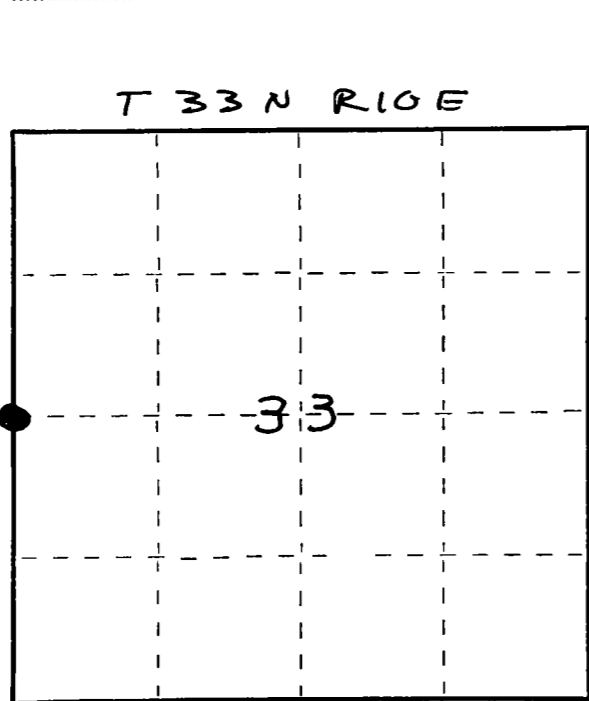

Dated at ELCHO, Wis., this 19<sup>th</sup> day of MARCH, 1980.

Signature William F. Kelly Title County Surveyor Registration No. 51098  
 (County Surveyor, Registered Land Surveyor, or other duly authorized official)

Office of Register of Deeds, County of \_\_\_\_\_, I hereby certify that the within instrument was filed in this office for record on the \_\_\_\_\_ day of \_\_\_\_\_, 19\_\_\_\_ at \_\_\_\_\_ o'clock \_\_\_\_\_ M.

(Register of Deeds)

By \_\_\_\_\_ Deputy

○ = Corner monument restored.