

CERTIFIED LAND CORNER RESTORATION

Index No. V-11

State of Wisconsin }  
County of LANGLADE } ss.

I William F. Kelly, do hereby certify that on the 25<sup>th</sup> day of February, 1980, I found evidence of the North 1/4 corner of SECT 33 Township 33 N, Range 10 E, Fourth Principal Meridian, as described hereon; and that from this evidence I established a new monument and accessories as described hereon to perpetuate the original location of this corner.

Resident witnesses:

Robert Hass Sr.

History of original corner establishment:  
ORIGINAL CORNER SET BY  
HIRAM FELLOWS IN  
OCT. 1860.

Description of corner evidence found:

Original corner evidence not available  
Set corner at mid point between  
The NW and NE section corners  
of sect 33 T33N R10E.

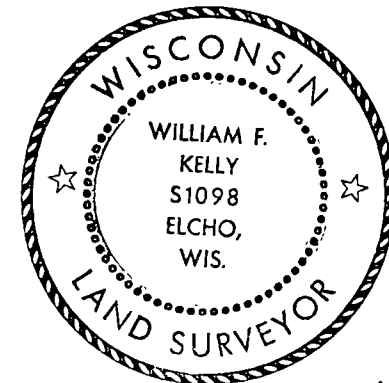

William F. Kelly

Description of monument and accessories I established to perpetuate the original location of this corner.

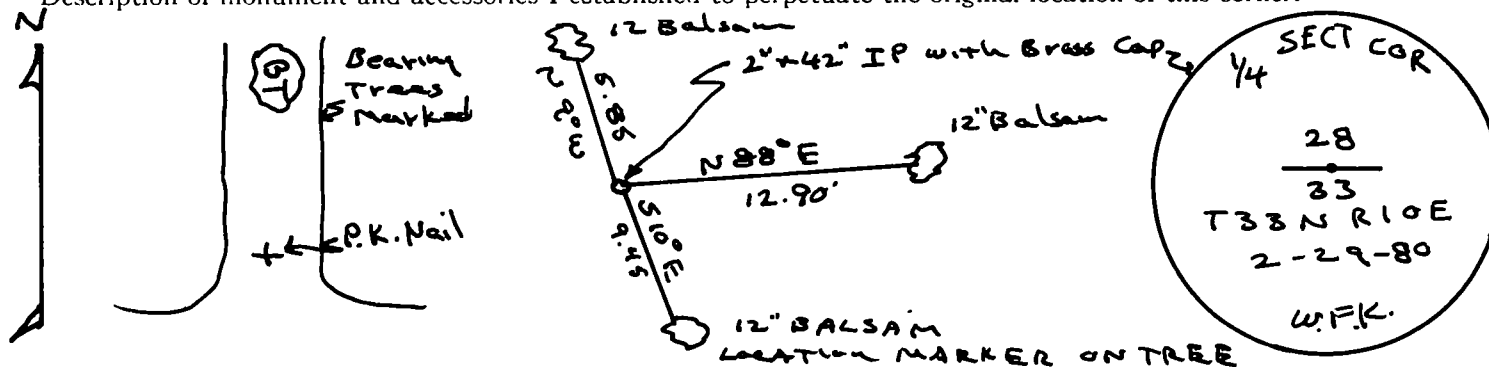

Dated at ELCHO, Wis., this 6<sup>th</sup> day of MARCH, 1980

Signature William F. Kelly Title County Surveyor Registration No. 5-1098  
(County Surveyor, Registered Land Surveyor, or other duly authorized official)

Office of Register of Deeds, County of \_\_\_\_\_, I hereby certify that the within instrument was filed in this office for record on the \_\_\_\_\_ day of \_\_\_\_\_, 19\_\_\_\_ at \_\_\_\_\_ o'clock \_\_\_\_\_ M.

(Register of Deeds)

By \_\_\_\_\_ Deputy

FORM 985 M. C. MILLER CO. MILWAUKEE

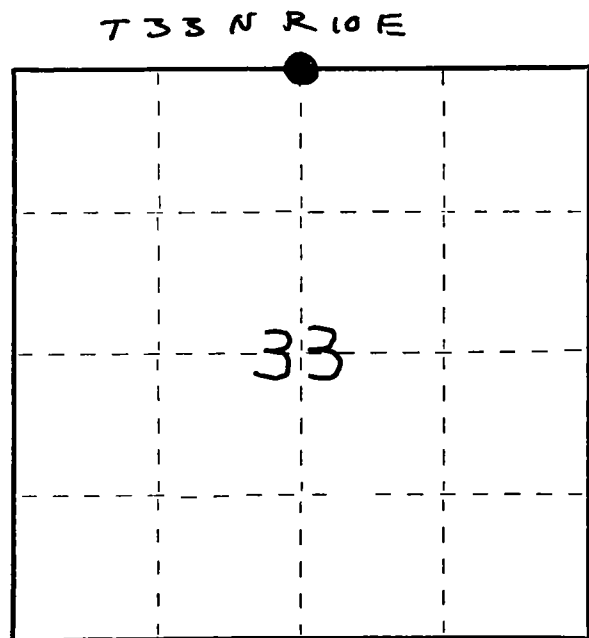

○ = Corner monument restored.