

CERTIFIED LAND CORNER RESTORATION

33-10
Index No. T-20

State of Wisconsin }
County of LANGLADE } ss.

I RAYMOND J. HALLISY, do hereby
certify that on the 26TH day
of MAY, 1973, I found
evidence of the EAST CENTER 1/16
corner of SECTION 26
Township 33, North, Range
10E, Fourth Principal Meridian,
as described hereon; and that from this evidence
I established a new monument and accessories
as described hereon to perpetuate the original
location of this corner.

Resident witnesses:

.....
.....
.....

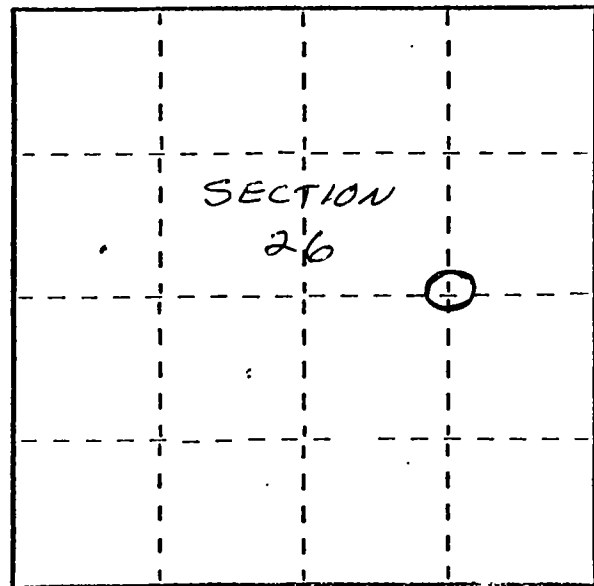

○ = Corner monument restored.

History of original corner establishment:

SET IN DEPENDENT RESURVEY
AND EXTENSION SURVEY IN 1931
SECTION 26 T33N-R10E

BY ARTHUR W. BROWN
U.S. CADASTRAL ENGINEER

Description of corner evidence found:

ORIGINAL BT WHITE PINE 16" N66 1/2 W 82 LKS.
ROCK MOUND - HOLE WHERE STAKE HAD BEEN
MARKS ON WHITE PINE BT PLAIN.

Description of monument and accessories I established to perpetuate the original location of this corner.

SET 2 INCH IRON PIPE WITH BRASS CAP
ROCK MOUND
NEW B.T.'S
RED MAPLE 6 INCH N57E 20.5 LKS.
RED MAPLE 4 INCH N55W 12.7 LKS

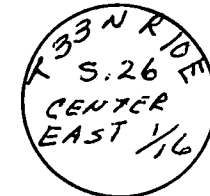

Dated at ANTIGO, Wis., this 26TH day of MAY, 1973

Signature Raymond J. Hallisy Title Reg Land Surveyor Registration No. 5-685
(County Surveyor, Registered Land Surveyor, or other duly authorized official)

Office of Register of Deeds, County of....., I hereby certify that the within
instrument was filed in this office for record on the.....day of....., 19.....
at.....o'clock..... M.

.....
(Register of Deeds)

By.....Deputy