

CERTIFIED LAND CORNER RESTORATION

Index No. V-22-23

State of Wisconsin }
County of Langlade } ss.

I Raymond J. Hallisy, do hereby certify that on the 5th day of April, 1930, I found evidence of the Meander corner of Section 25 & 36 Township 33, North, Range 10E, Fourth Principal Meridian, as described hereon; and that from this evidence I established a new monument and accessories as described hereon to perpetuate the original location of this corner.

Resident witnesses:

.....
.....
.....

History of original corner establishment:

Corner set in the Dependent & Extension Survey of Sections 26, 35, & 36 T33N R10E in 1930.

Description of corner evidence found:

3" brass cap set in 5" of cement on the west shore of Lower Bass Lake.

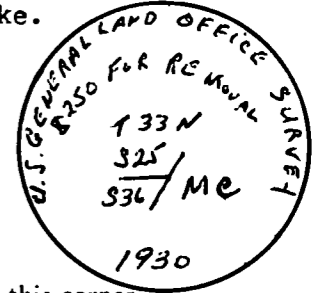

Description of monument and accessories I established to perpetuate the original location of this corner.

New BT's

- 8" White Birch N22E 24'2"
- 8" White Birch N27W 9'10"
- 10" White Birch S42W 26'9"

Dated at Antigo, Wis., this 5th day of April, 1930

Signature Raymond J. Hallisy Title Reg. Land Surveyor Registration No. S-685
(County Surveyor, Registered Land Surveyor, or other duly authorized official)

Office of Register of Deeds, County of....., I hereby certify that the within instrument was filed in this office for record on the..... day of....., 19..... at..... o'clock..... M.

(Register of Deeds)

By..... Deputy

FORM 985 H. C. MILLER CO., MILWAUKEE

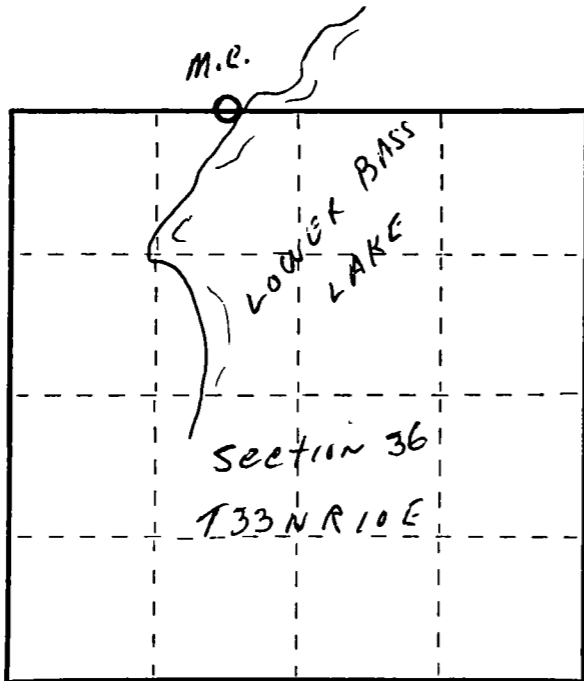

○ = Corner monument restored.