

CERTIFIED LAND CORNER RESTORATION

Index No. R-11

State of Wisconsin }  
County of LANGLADE } ss.

History of original corner establishment:  
CAP SET IN 1930'S BY CCC CONTRACT.

I, WILLIAM F. KELLY, do hereby certify that on the 29<sup>TH</sup> day of JULY, 1976, I found evidence of the 1/4 SECTION corner of SECTIONS 21 & 28 Township 33, North, Range 10E, Fourth Principal Meridian, as described hereon; and that from this evidence I established a new monument and accessories as described hereon to perpetuate the original location of this corner.

Resident witnesses:

E. MISHLER

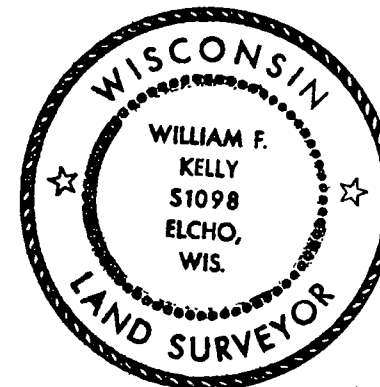

*William F. Kelly*

Description of corner evidence found:  
3" GALVANIZED CAP MARKED (1/4)

Description of monument and accessories I established to perpetuate the original location of this corner.

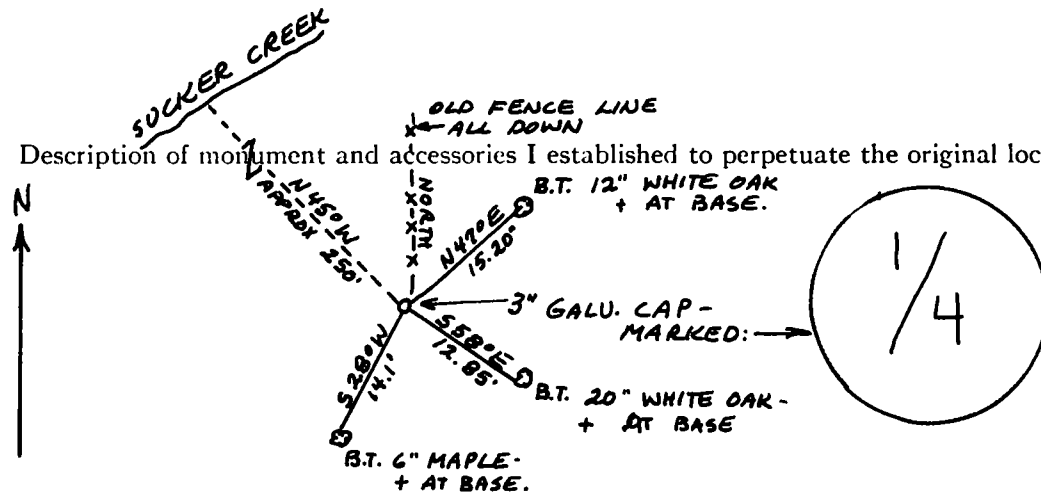

MARKED BEARING TREES.  
NOTE: CORNER IS ON A SIDE HILL SLOPE IN A HARDWOOD FOREST.

FORM 985 H. C. MILLER CO., MILWAUKEE

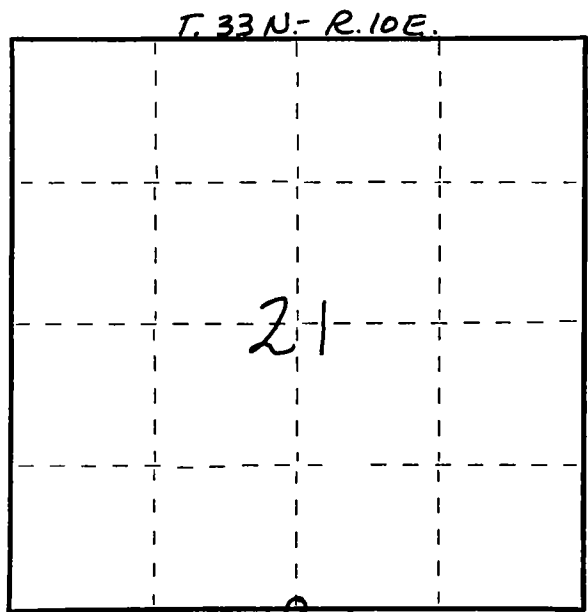

○ = Corner monument restored.

Dated at ELCHO, Wis., this 29<sup>TH</sup> day of JULY, 1976

Signature William F. Kelly Title REGISTERED LAND SURVEYOR Registration No. 51098  
(County Surveyor, Registered Land Surveyor, or other duly authorized official)

Office of Register of Deeds, County of \_\_\_\_\_, I hereby certify that the within instrument was filed in this office for record on the \_\_\_\_\_ day of \_\_\_\_\_, 19\_\_\_\_ at \_\_\_\_\_ o'clock \_\_\_\_\_ M.

(Register of Deeds)

By \_\_\_\_\_ Deputy