

CERTIFIED LAND CORNER RESTORATION

Index No. P-8

33-10

State of Wisconsin }
County of Lan glade } ss.

History of original corner establishment:

CORNER set in The 1930's by LYTLE - C.C.C. ERA

I, Raymond J. Hallisy, do hereby certify that on the 11th day of Sept, 1976, I found evidence of the EAST CENTER 1/16 corner of Section 20 Township 33, North, Range 10E, Fourth Principal Meridian, as described hereon; and that from this evidence I established a new monument and accessories as described hereon to perpetuate the original location of this corner.

Description of corner evidence found:

Wood post down, point in Ground
OLD BT'S

8" cedar stump N60E 10 1/2 LKS
10" cedar S42E 14 LKS

Resident witnesses:

Description of monument and accessories I established to perpetuate the original location of this corner.

Set 1 1/2" IRON pipe with brass cap

NEW BT'S

8" cedar N5W 29.3 LKS
8" cedar S22W 23.8 LKS

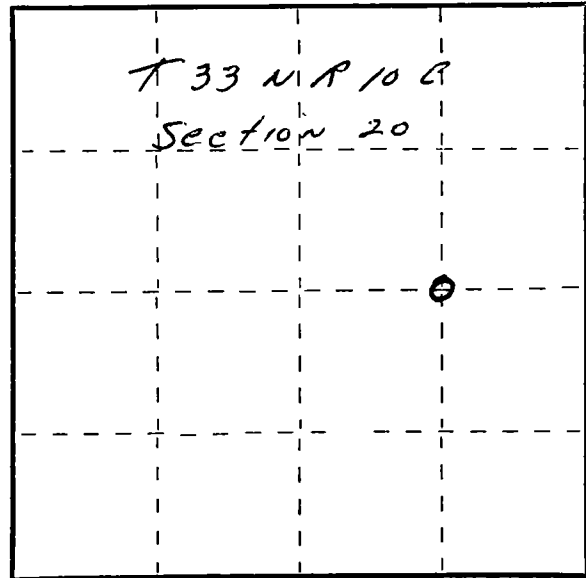
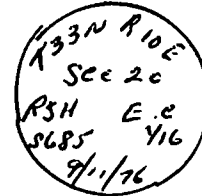

○ = Corner monument restored.

Dated at Antigo, Wis., this 11th day of Sept, 1976

Signature Raymond J. Hallisy Title Land Surveyor Registration No. 5685
(County Surveyor, Registered Land Surveyor, or other duly authorized official)

Office of Register of Deeds, County of _____, I hereby certify that the within instrument was filed in this office for record on the _____ day of _____, 19____ at _____ o'clock _____ M.

(Register of Deeds)

By _____ Deputy