

CERTIFIED LAND CORNER RESTORATION

Index No. P-9

State of Wisconsin }
County of Langlade } ss.

History of original corner establishment:

Sept. 24, 1938

I Raymond S. Hallisy, do hereby certify that on the 4th day of Sept., 1976, I found evidence of the Y4 corner of Section 20 & 21 Township 33, North, Range 10E, Fourth Principal Meridian, as described hereon; and that from this evidence I established a new monument and accessories as described hereon to perpetuate the original location of this corner.

Description of corner evidence found:

4" IRON PIPE WITH BRASS CAP

Resident witnesses:

.....
.....
.....

Description of monument and accessories I established to perpetuate the original location of this corner.

New BT's

5" HARD MAPLE S34 W 4' 8"
12" HARD MAPLE S84 E 17' 1"
5" HARD MAPLE N42 E 11"

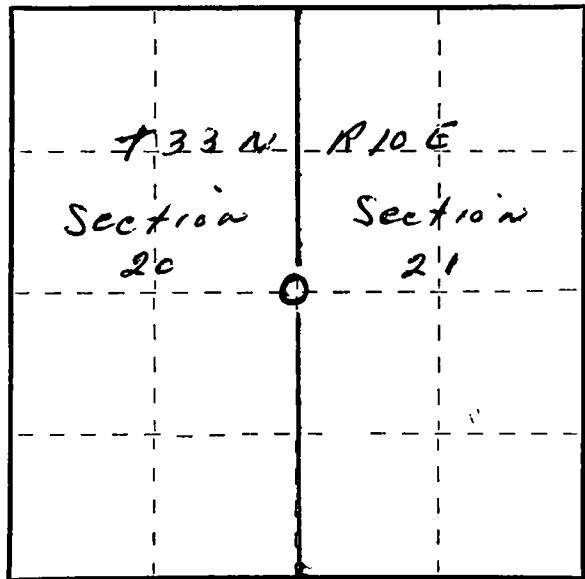
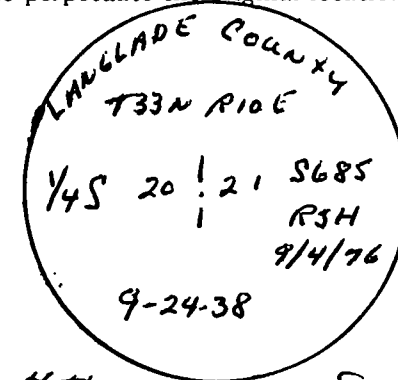

○ = Corner monument restored.

Dated at Ashtico, Wis., this 4th day of Sept., 1976.

Signature Raymond S. Hallisy Title Reg. Land Surveyor Registration No. 5685
(County Surveyor, Registered Land Surveyor, or other duly authorized official)

Office of Register of Deeds, County of....., I hereby certify that the within instrument was filed in this office for record on the..... day of....., 19..... at..... o'clock..... M.

.....
(Register of Deeds)

By..... Deputy