

CERTIFIED LAND CORNER RESTORATION

Index No. **97**

33-10

State of Wisconsin }
County of Lannglade } ss.

I, Raymond S. Hallisy, do hereby certify that on the 18th day of Sept, 1976, I found evidence of the South Center 1/8 corner of Section 20 Township 33, North, Range 12E, Fourth Principal Meridian, as described hereon; and that from this evidence I established a new monument and accessories as described hereon to perpetuate the original location of this corner.

Resident witnesses:
.....
.....
.....

History of original corner establishment:

CORNER SET IN THE 1930's by LITTLE - CCC. EAA

Description of corner evidence found:

WOOD POST DOWN, POINT IN GROUND - MARKED 1/8
12" CEDAR N17E 12 LKS - STANDING
8" CEDAR, S25W 7 LKS - DOWN

Description of monument and accessories I established to perpetuate the original location of this corner.

SET NEW CEDAR POST - MARKED 1/8
NEW BT
10" CEDAR N75E 19 1/2 LKS

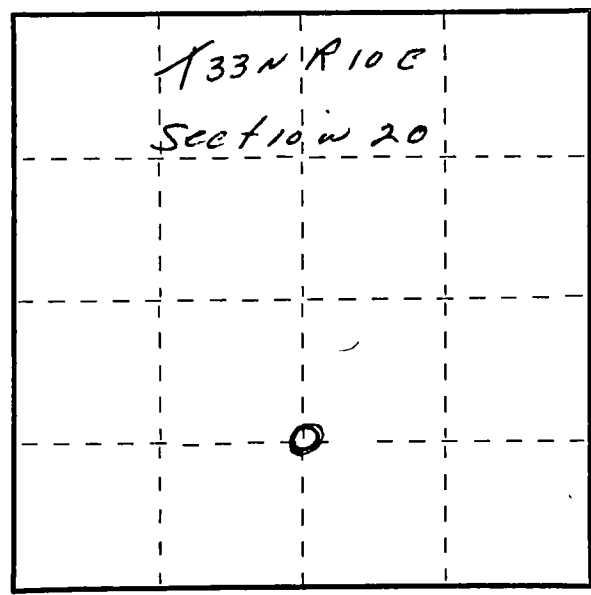

○ = Corner monument restored.

Dated at Antigo, Wis., this 18th day of Sept, 1976.

Signature Raymond S. Hallisy Title Reg Land Surveyor Registration No. 5-685
(County Surveyor, Registered Land Surveyor, or other duly authorized official)

Office of Register of Deeds, County of....., I hereby certify that the within instrument was filed in this office for record on the..... day of....., 19..... at..... o'clock..... M.

.....
(Register of Deeds)

By..... Deputy

FORM 985 H. C. MILLER CO., MILWAUKEE