

CERTIFIED LAND CORNER RESTORATION

33-10

Index No. K-25

State of Wisconsin }  
County of Lanlade } ss.

History of original corner establishment:

Corner set in the 1930 resurvey.

I Raymond J. Hallisy do hereby certify that on the 13th day of June, 19 71, I found evidence of the N 1/16 corner of Section 18 & 17 Township 33, North, Range 10E, Fourth, Principal Meridian, as described hereon; and that from this evidence I established a new monument and accessories as described hereon to perpetuate the original location of this corner.

Description of corner evidence found:

Found old wood stake down, Rock mound, Marked S18 S17

Resident witnesses:

.....  
.....  
.....

Description of monument and accessories I established to perpetuate the original location of this corner.

Set 2" pipe with brass cap, rock mound

BT's to corner  
12" Hard Maple N74E 13 Feet 10 inches  
9" Hard Maple S62W 9 Feet 10 inches  
BT's faced at base of tree and scribed BT.



FORM 985 M. C. MILLER CO., MILWAUKEE

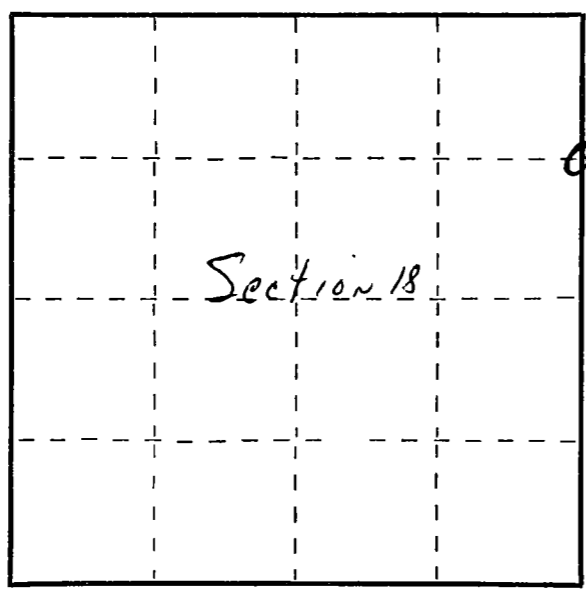

○ = Corner monument restored.

Dated at Antigo, Wis., this 13th day of June, 19 71

Signature Ray J. Hallisy Title Reg. Land Surveyor Registration No. 5-680  
(County Surveyor, Registered Land Surveyor, or other duly authorized official)

Office of Register of Deeds, County of....., I hereby certify that the within instrument was filed in this office for record on the.....day of....., 19..... at.....o'clock..... M.

.....  
(Register of Deeds)

By.....Deputy