

CERTIFIED LAND CORNER RESTORATION

Index No. L-5

State of Wisconsin }
County of LANGLADE } ss.

Raymond S. Hallisy, do hereby certify that on the 4th day of Sept, 1976, I found evidence of the 1/4 corner of Section 17 & 18 Township 33, North, Range 10E, Fourth Principal Meridian, as described hereon; and that from this evidence I established a new monument and accessories as described hereon to perpetuate the original location of this corner.

Resident witnesses:

.....
.....
.....

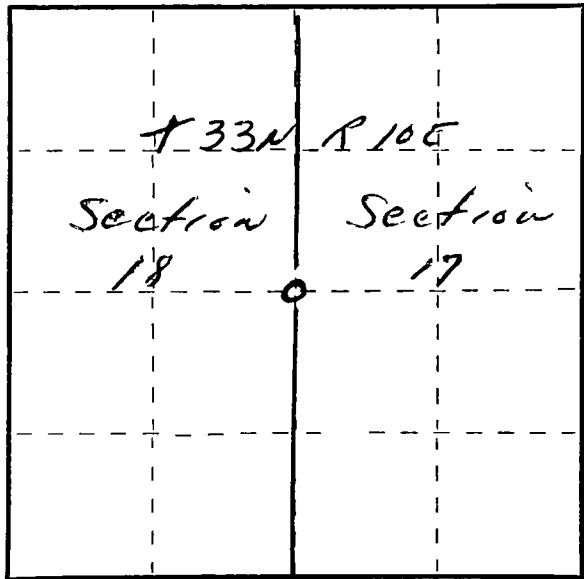

○ = Corner monument restored.

History of original corner establishment:

Oct. 10, 1938

Description of corner evidence found:

4" IRON PIPE WITH BRASS CAP
OLD BT'S
CEDAR 12" N37E 11.2 LKS
BLACKASH 10" N35W 28 LKS

Description of monument and accessories I established to perpetuate the original location of this corner.

NEW BT'S
8" CEDAR N67E 13'8"
9" BALSAM S43E 4'9"

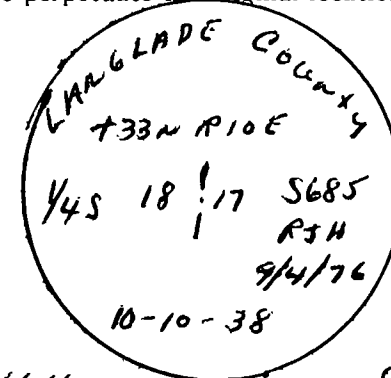

Dated at Antigo, Wis., this 4th day of Sept, 1976.

Signature Raymond S. Hallisy Title Reg. Land Surveyor Registration No. 5685
(County Surveyor, Registered Land Surveyor, or other duly authorized official)

Office of Register of Deeds, County of....., I hereby certify that the within instrument was filed in this office for record on the..... day of....., 19..... at..... o'clock..... M.

.....
(Register of Deeds)

By..... Deputy