

CERTIFIED LAND CORNER RESTORATION

33-10
Index No. N-24

State of Wisconsin }
County of Lanlade } ss.

History of original corner establishment:

Corner set in the 1930's by: D. A. Hintz
Ed. Vanish
L. P. Mason
C. W. Borth

I Raymond J. Hallisy, do hereby certify that on the 29th day of May, 1968, I found evidence of the E 1/16 corner of Section 24 Township 33, North, Range 10, Fourth, Principal Meridian, as described hereon; and that from this evidence I established a new monument and accessories as described hereon to perpetuate the original location of this corner.

Description of corner evidence found:

Found squared stake and rock mound.
Stake marked 1/8 13 24 W. C. C. 25 LKS N.

Resident witnesses:

.....
.....
.....

Description of monument and accessories I established to perpetuate the original location of this corner.

Set Std. 1 1/2" pipe with cap marked E 1/16 W. C. C. 25 LKS N. rock mound.
B T witness the W. C.

FORM 585 H C MILLER CO., MILWAUKEE

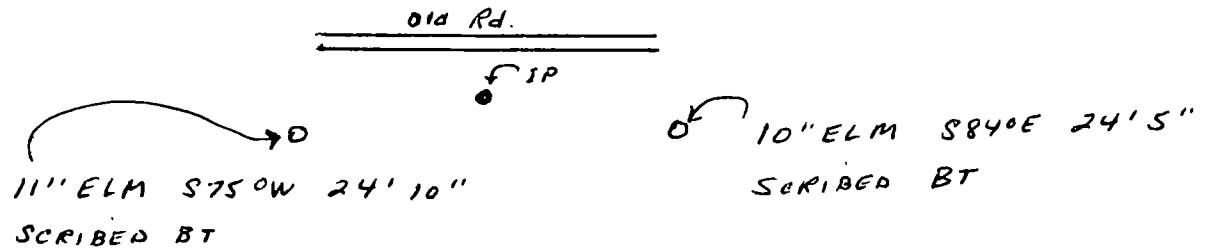
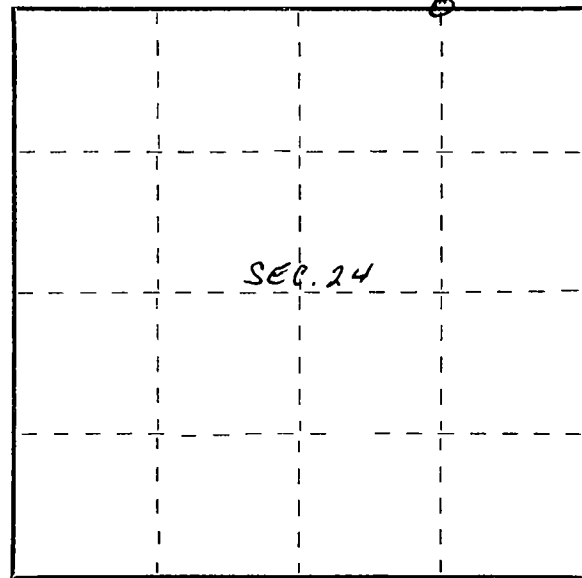

Dated at Antigo, Wis., this 29th day of May, 1968.

Signature Raymond J. Hallisy Title Reg. Land Surveyor Registration No. S-685
(County Surveyor, Registered Land Surveyor, or other duly authorized official)

Office of Register of Deeds, County of _____, I hereby certify that the within instrument was filed in this office for record on the _____ day of _____, 19____ at _____ o'clock _____ M.

(Register of Deeds)

By _____ Deputy

○ = Corner monument restored.