

CERTIFIED LAND CORNER RESTORATION

Index No. H-21
H-J 21

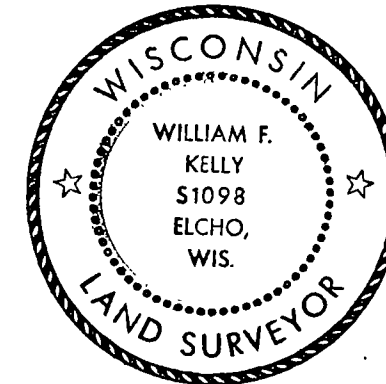

William F. Kelly

State of Wisconsin }
County of LANGLADE } ss.

I, WILLIAM F. KELLY, do hereby certify that on the 4TH day of DECEMBER, 1975, I found evidence of the MEANDER CORNER corner of SECTIONS 11 & 12 Township 33, North, Range 10E, Fourth Principal Meridian, as described hereon; and that from this evidence I established a new monument and accessories as described hereon to perpetuate the original location of this corner.

History of original corner establishment:

Description of corner evidence found:

FOUND MEANDER CORNER ON SOUTH SHORE BASS LAKE. 2" B.I. PIPE IDENTIFIED BY RESIDENT WITNESS AS THE MEANDER CORNER.

Resident witnesses:

MR. WHEELER

Description of monument and accessories I established to perpetuate the original location of this corner.

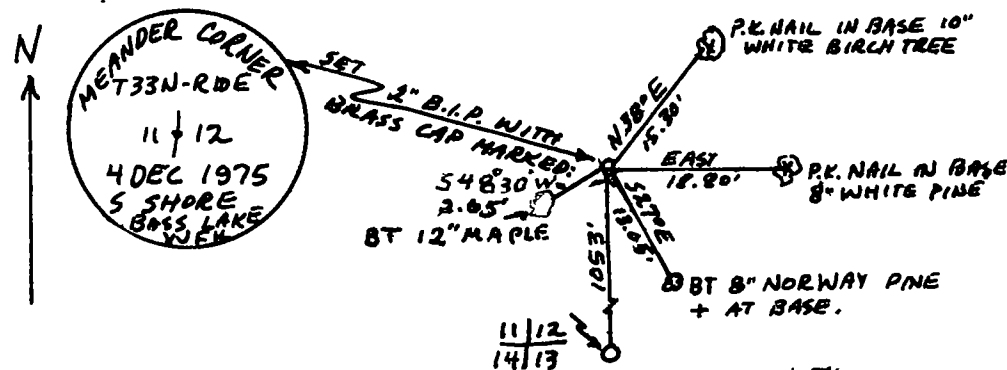

NOTE: CORNER IS ALSO THE NW CORNER OF LOT 1 BLOCK NO. 6 OF LANGLADE BEACH PLAT 2ND ADDITION.

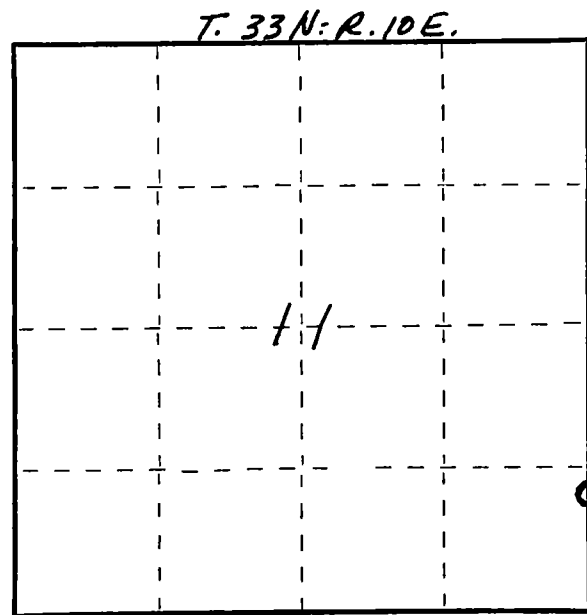

Dated at ELCHO, Wis., this 4TH day of DECEMBER, 1975

Signature William F. Kelly Title REGISTERED LAND SURVEYOR Registration No. S1098
(County Surveyor, Registered Land Surveyor, or other duly authorized official)

Office of Register of Deeds, County of _____, I hereby certify that the within instrument was filed in this office for record on the _____ day of _____, 19____ at _____ o'clock _____ M.

(Register of Deeds)

By _____ Deputy

○ = Corner monument restored.

FORM 985 H. C. MILLER CO., MILWAUKEE