

CERTIFIED LAND CORNER RESTORATION

Index No. J-15

State of Wisconsin }  
County of Langlade } ss.

I, Raymond J. Hallisy, do hereby certify that on the 11th day of March, 1981, I found evidence of the 1/4 corner of Section 10 & 15 Township 33, North, Range 10E, Fourth Principal Meridian, as described hereon; and that from this evidence I established a new monument and accessories as described hereon to perpetuate the original location of this corner.

Resident witnesses:  
.....  
.....  
.....

History of original corner establishment:  
Corner set in the 1930 resurvey.

Description of corner evidence found:  
4" pipe with brass cap  
Stone with X N60E 39.21 Links  
Stone with X N85W 26.6 Links

Description of monument and accessories I established to perpetuate the original location of this corner.

New BT's

12"	Hard Maple	S66E	30'6"
12"	Hard Maple	N24E	4'3"
14"	Hard Maple	S70W	12'8"

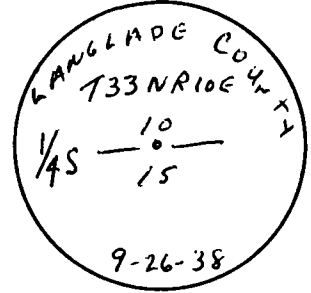

FORM 985 M. C. MILLER CO., MILWAUKEE

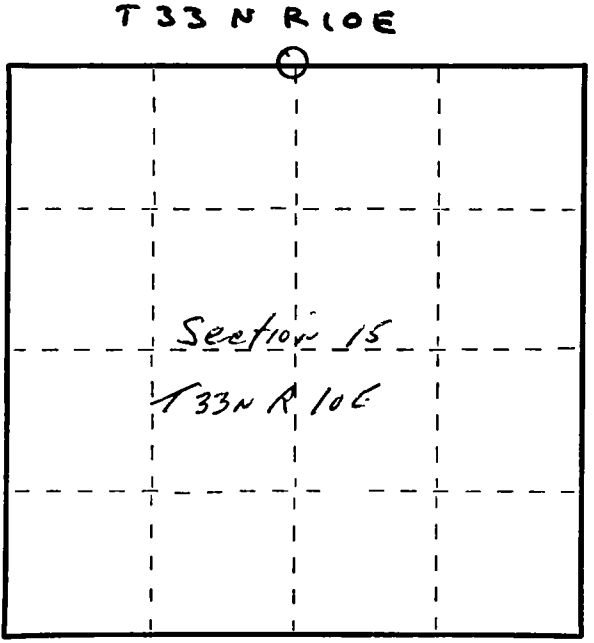

○ = Corner monument restored.

Dated at Antigo, Wis., this 11th day of March, 1981.  
Signature Raymond J. Hallisy Title Reg. Surveyor Registration No. S-685  
(County Surveyor, Registered Land Surveyor, or other duly authorized official)

Office of Register of Deeds, County of \_\_\_\_\_, I hereby certify that the within instrument was filed in this office for record on the \_\_\_\_\_ day of \_\_\_\_\_, 19\_\_\_\_ at \_\_\_\_\_ o'clock \_\_\_\_\_ M.

.....  
(Register of Deeds)  
By..... Deputy