

CERTIFIED LAND CORNER RESTORATION

Index No. E-13

State of Wisconsin }
 County of LANGLADE } ss.

I WILLIAM F. KELLY, do hereby certify that on the 25th day of FEB., 1981, I found evidence of the SE corner of SEC. 4 Township 33, North, Range 10 EAST, Fourth Principal Meridian, as described hereon; and that from this evidence I established a new monument and accessories as described hereon to perpetuate the original location of this corner.

Resident witnesses:

.....

FORM 985 H. C. MILLER CO. - MILWAUKEE

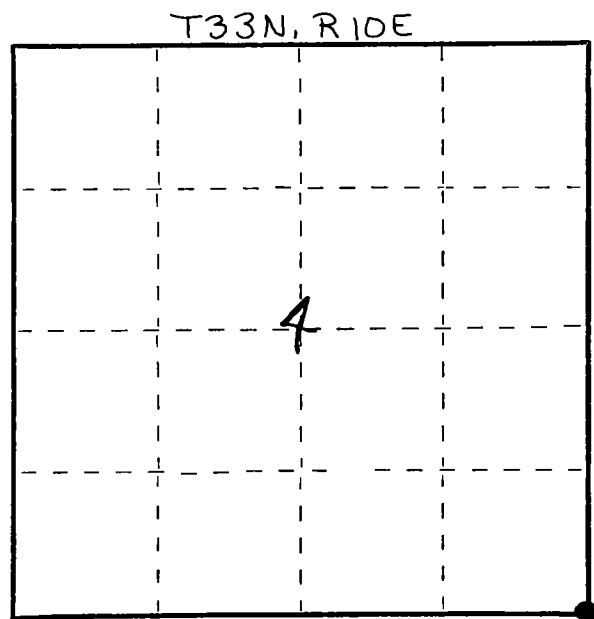

○ = Corner monument restored.

History of original corner establishment:
 ORIGINAL CORNER ESTABLISHED
 BY HIRAM C. FELLOWS IN 1860.

Description of corner evidence found:
 FOUND 4" BRASS CAP MONUMENT SET IN 1938
 IN PLACE WITH 1 BT STUMP.
 MARK NEW WITNESS COR.



William F. Kelly

Description of monument and accessories I established to perpetuate the original location of this corner.

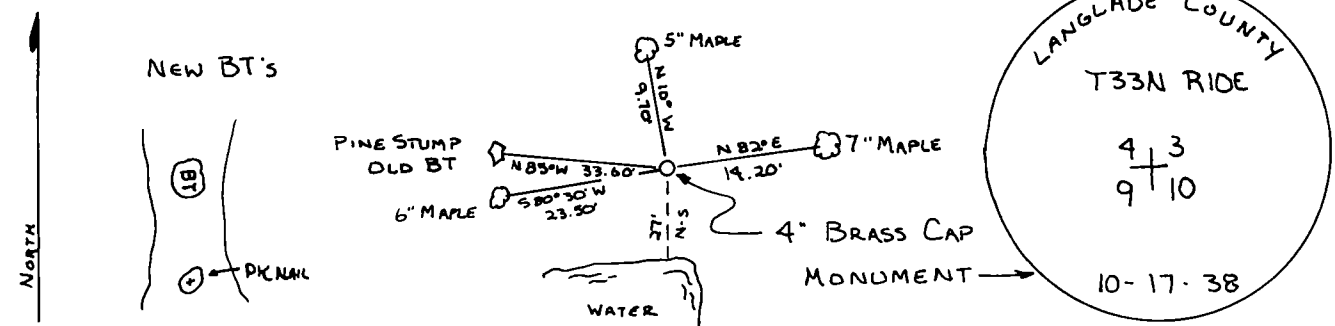

Dated at ELCHO, Wis., this 25th day of FEB., 1981.

Signature William F. Kelly Title COUNTY SURVEYOR Registration No. 1098
 (County Surveyor, Registered Land Surveyor, or other duly authorized official)

Office of Register of Deeds, County of, I hereby certify that the within instrument was filed in this office for record on the day of, 19..... at o'clock M.

.....
 (Register of Deeds)
 By..... Deputy