

CERTIFIED LAND CORNER RESTORATION

Index No. E-23

State of Wisconsin }  
County of LANGLADE } ss.

I WILLIAM F. KELLY, do hereby certify that on the 5<sup>th</sup> day of APRIL, 19 75, I found evidence of the 1/4 SECTION corner of SECTIONS 1 & 12 Township 33, North, Range 10 E, Fourth Principal Meridian, as described hereon; and that from this evidence I established a new monument and accessories as described hereon to perpetuate the original location of this corner.

Resident witnesses:

O. Raith  
.....  
.....  
.....

FORM 985 H. C. MILLER CO., MILWAUKEE

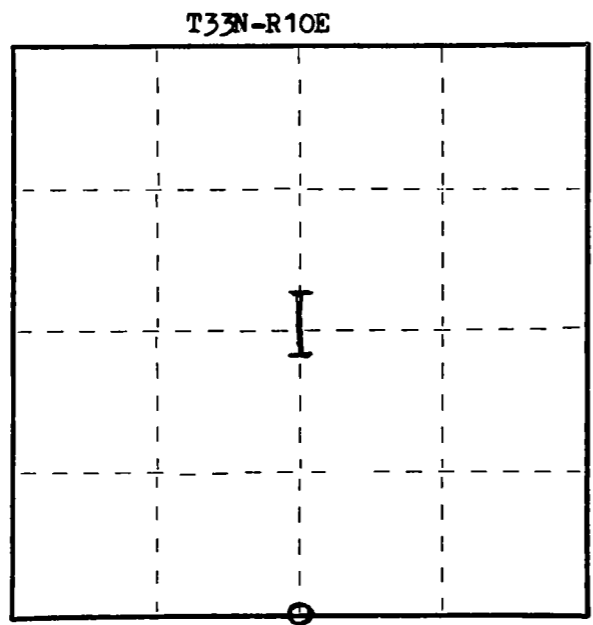

○ = Corner monument restored.

History of original corner establishment:

Description of corner evidence found:

LOCATED A 3" PIPE WITH GALVANIZED CAP. ALSO FOUND OLD BLAZE ON 18" HEMLOCK. CORNER IDENTIFIED BY RESIDENT WITNESS AS THE 1/4 COR. SECT. T.33N.-R.10E.

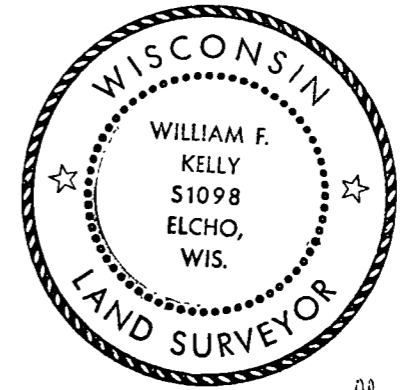

*William F. Kelly*

Description of monument and accessories I established to perpetuate the original location of this corner.

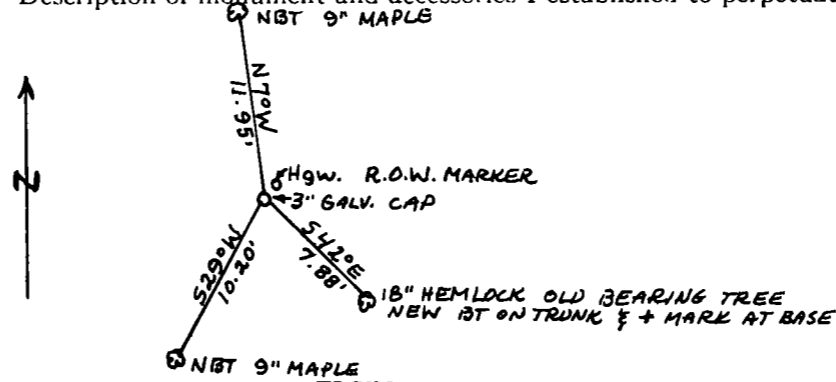

GALVANIZED CAP MARKED:

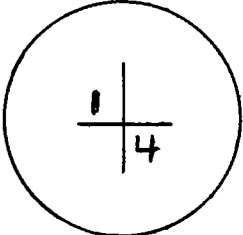

CORNER WITNESSED WITH NEW BEARING TREES. TREES BLAZED NBT ON TRUNK & MARKED WITH + AT BASE.

Dated at ELCHO, Wis., this 5<sup>th</sup> day of APRIL, 19 75

Signature William F. Kelly Title REGISTERED LAND SURVEYOR. Registration No. S 1098  
(County Surveyor, Registered Land Surveyor, or other duly authorized official)

Office of Register of Deeds, County of ....., I hereby certify that the within instrument was filed in this office for record on the ..... day of ....., 19 ..... at ..... o'clock ..... M.

(Register of Deeds)

By ..... Deputy