

CERTIFIED LAND CORNER RESTORATION

Index No. X-29

State of Wisconsin }
Langlade } ss.
County of.....

History of original corner establishment:
No evidence of any previous corner.

I, Glen Barker, do hereby
certify that on the 11th day
of February, 19 83, I found
~~evidence of the~~ EC 1/16
corner of Section 36
Township 33 North, Range
9 East, Fourth Principal Meridian,
as described hereon; and that from this evidence
I established a new monument and accessories
as described hereon to perpetuate the original
location of this corner.

Description of corner evidence found:
Total distance from 1/4 corner between sections 36 & 31, T33N R9 & 10E to C 1/4
section 36 is 2633.11 ft. Set EC 1/16 1316.55 ft. intermediate.

Resident witnesses:

J. Claflin - R.L.S.
H. Wagoner

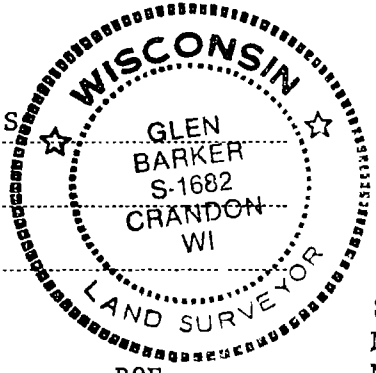

Description of monument and accessories I established to perpetuate the original location of this corner.

Set a 2" iron pipe with brass cap stamped:
Monument projects 12" above ground.
Marked NBTs
Yellow birch 7" N89E 3.11 ft.
Maple 9" S49W 10.37 ft.
Scribed 1/16

T33N R9E
EC 1/16 S 36
S1682 - 1983

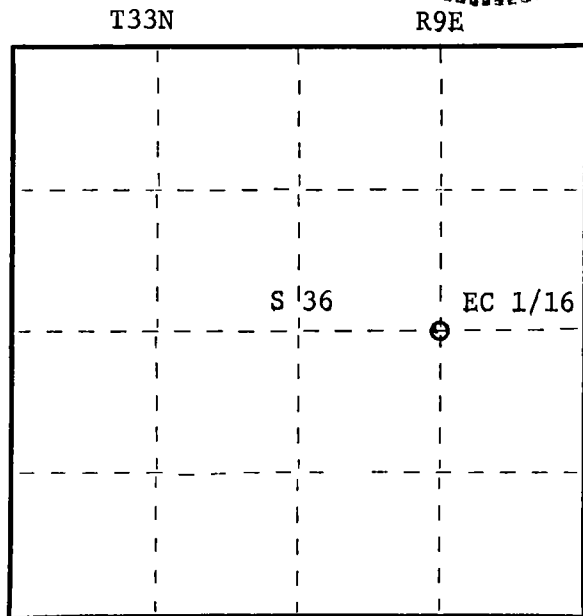

○ = Corner monument restored.

Dated at Rhineland, Wis., this 11th day of May, 19 83.

Signature: Glen Barker Title Registered Land Surveyor Registration No. S1682
(County Surveyor, Registered Land Surveyor, or other duly authorized official)

Office of Register of Deeds, County of....., I hereby certify that the within
instrument was filed in this office for record on the..... day of....., 19.....
at..... o'clock..... M.

(Register of Deeds)

By..... Deputy

FORM 985 H.C. Miller Company Stock No. 26272