

CERTIFIED LAND CORNER RESTORATION

Index No. 1-29

State of Wisconsin }
County of Langlade } ss.

History of original corner establishment:
No evidence of any previous corner.

I, Glen Barker, do hereby certify that on the 11th day of February, 19 82, I ~~found~~ found evidence of the SE 1/16 corner of Section 36 Township 33, North, Range 9 East, Fourth Principal Meridian, as described hereon; and that from this evidence I established a new monument and accessories as described hereon to perpetuate the original location of this corner.

Description of corner evidence found:
Corner established by subdivision of the SE 1/4.
Corner sets 1323.86 ft. of EC 1/16 and 1315.95 ft. of SC 1/16.

Resident witnesses:

J. Claflin - R.L.
H. Wagoner

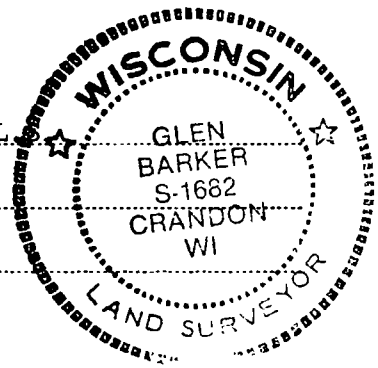

Description of monument and accessories I established to perpetuate the original location of this corner.

Set a 1" iron pipe with 2" diameter alloy cap stamped:

Monument projecting 18" above ground.
Marked NBTs
Maple 6" S38W 8.20 ft.
Maple 8" N59W 28.65 ft.
Scribed 1/16 - B.T.

S1682
T33N R9E
S 36
SE 1/16
CPI - 1983

FORM 985
H.C. Munn Company
Stock No. 26272

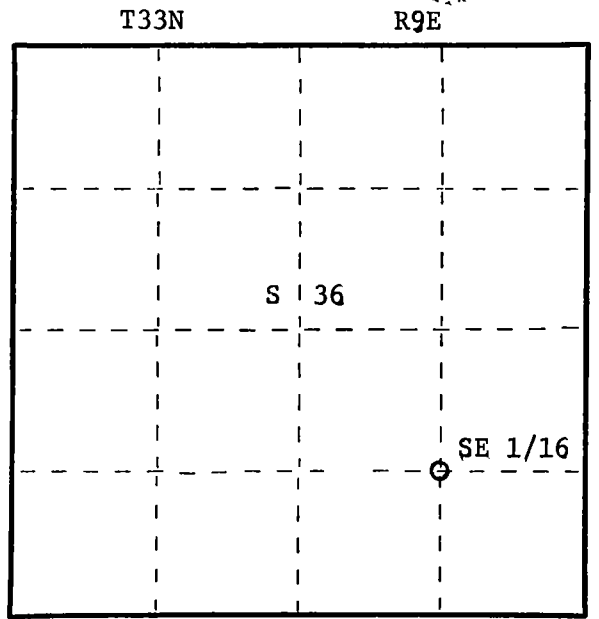

○ = Corner monument restored.

Dated at Rhineland, Wis., this 11th day of May, 19 83
Signature Glen Barker Title Registered Land Surveyor Registration No. S1682
(County Surveyor, Registered Land Surveyor, or other duly authorized official)

Office of Register of Deeds, County of....., I hereby certify that the within instrument was filed in this office for record on the..... day of....., 19..... at..... o'clock..... M.

(Register of Deeds)

By.....Deputy