

CERTIFIED LAND CORNER RESTORATION

Index No. X-18

State of Wisconsin }
County of Langlade } ss.

I Daniel K. Pleoger, do hereby certify that on the 15 day of January, 1982, I found ~~found~~ Est. ~~corner~~ of the WC 1/16 corner of Section 35 Township 33, North, Range 9 East, Fourth Principal Meridian, as described hereon; and that from this evidence I established a new monument and accessories as described hereon to perpetuate the original location of this corner.

Resident witnesses:

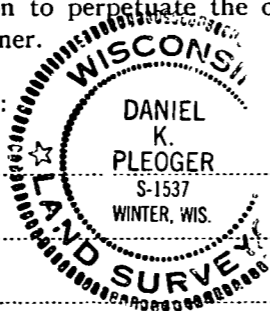

History of original corner establishment:

No evidence of any previous corner.

Description of corner evidence found:

Total distance from 1/4 corner between sections 34 & 35 to C 1/4 corner section 35 is 2602.23 ft. at bearing S87-09-48E.
Set WC 1/16 corner 1301.115 ft. intermediate.

Description of monument and accessories I established to perpetuate the original location of this corner.

Set a 2" iron pipe with brass cap stamped:

Monument projects 12" above ground.

Marked NBTs:

Maple 6" N78W 16.85 ft.

Maple 6" S4°E 28.0 ft.

Scribed 1/16 - B.T.

T33N R9E

WC 1/16 S 35
S1537 - 1982

FORM 985 H. C. MILLER CO., MILWAUKEE

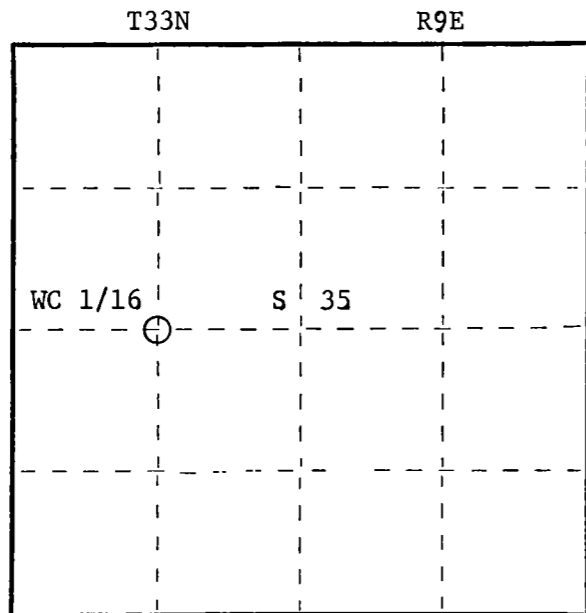

○ = Corner monument restored.

Dated at Rhinelander, Wis., this 26th day of April, 1982.

Signature: Daniel K. Pleoger Title: Registered Land Surveyor Registration No. 1537
(County Surveyor, Registered Land Surveyor, or other duly authorized official)

Office of Register of Deeds, County of _____, I hereby certify that the within instrument was filed in this office for record on the _____ day of _____, 19____ at _____ o'clock _____ M.

(Register of Deeds)

By _____ Deputy