

CERTIFIED LAND CORNER RESTORATION

Index No. **A-9**

T32N-R9E

State of Wisconsin }
County of LANGLADE } ss.

I, WILLIAM F. KELLY, do hereby certify that on the 9th day of Dec., 1981, I found evidence of the SE corner of Sec. 32 Township 32, North, Range 9 EAST, Fourth Principal Meridian, as described hereon; and that from this evidence I established a new monument and accessories as described hereon to perpetuate the original location of this corner.

Resident witnesses:

.....
.....
.....

History of original corner establishment:

ORIGINAL CORNER ESTABLISHED BY
HIRAM C. FELLOWS IN SEPT., 1860.

IRON BAR SET BY D. HINTZ
ABOUT 1936

RHINELANDER PAPER SET WIT. MON.
IN 1950'S

Description of corner evidence found:

IRON BAR AND 4" ALUMINUM CAP
WITNESS MONUMENT, FOUND IN
PLACE. SET PK NAIL OVER
IRON BAR.
MARKED ONE NEW WIT.
TREE + POWER POLE

Description of monument and accessories I established to perpetuate the original location of this corner.

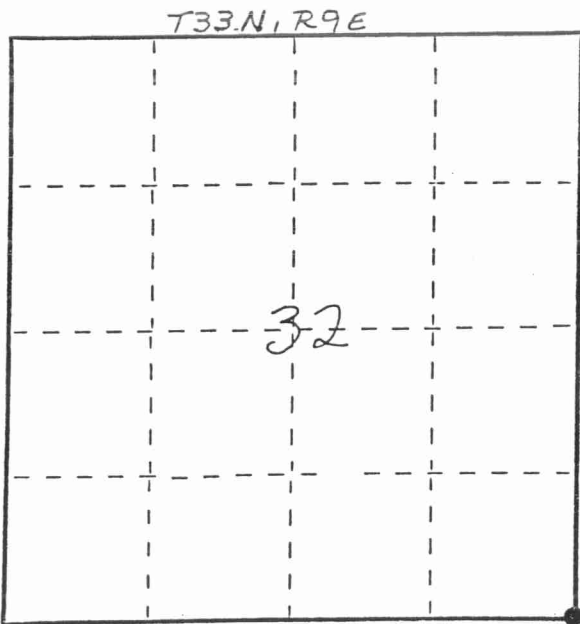
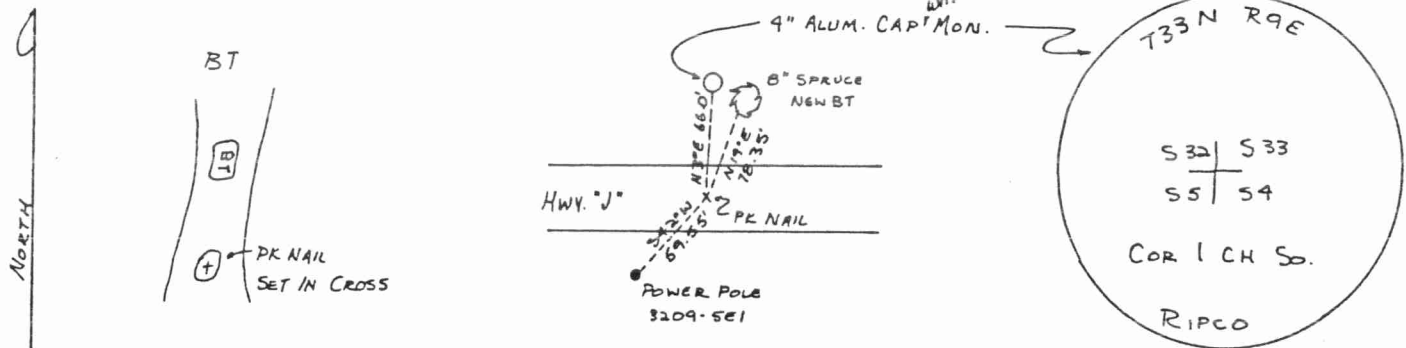

○ = Corner monument restored.

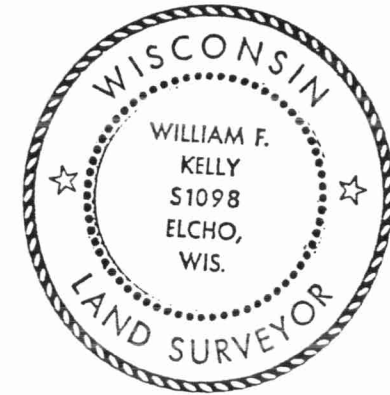

Dated at ELCHO, Wis., this 9th day of DEC., 1981

Signature William F. Kelly Title COUNTY SURVEYOR Registration No. 1098
(County Surveyor, Registered Land Surveyor, or other duly authorized official)

Office of Register of Deeds, County of....., I hereby certify that the within instrument was filed in this office for record on the..... day of....., 19..... at..... o'clock..... M.

.....
(Register of Deeds)

By..... Deputy