

CERTIFIED LAND CORNER RESTORATION

Index No. S-21

State of Wisconsin }
County of Langlade } ss.

History of original corner establishment:
Someone's old 1" iron pipe with cap stamped found buried in muck.

I, Glen Barker, do hereby
certify that on the 23rd day
of February, 1983, I found
evidence of the N 1/16
corner of Sections 25 & 26
Township 33, North, Range
9 East, Fourth Principal Meridian,
as described hereon; and that from this evidence
I established a new monument and accessories
as described hereon to perpetuate the original
location of this corner.

Resident witnesses:

J. Claflin - R.L.

H. Wagoner

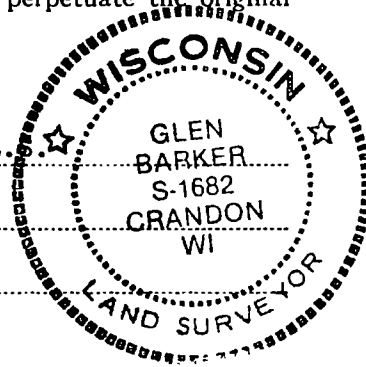

Description of corner evidence found:

Total distance from section corner 23-24-25-26 to previously established 1/4 corner
between sections 25 & 26 is 2715.84 ft.

Set N 1/16 1357.84 ft. intermediate.

At this position we recovered an old 1" iron pipe with cap stamped buried in muck in a
horizontal position.

Description of monument and accessories I established to perpetuate the original location of this corner.

Set a 1" iron pipe with 2" diameter alloy cap stamped:

S1682

Monument projects 18" above ground

T33N R9E

Marked NBTs

Yellow birch 6" North 18.88 ft.

N 1/16 26 25

Maple 9" N79E 27.37 ft.

Scribed 1/16 - B.T.

CPI - 1983

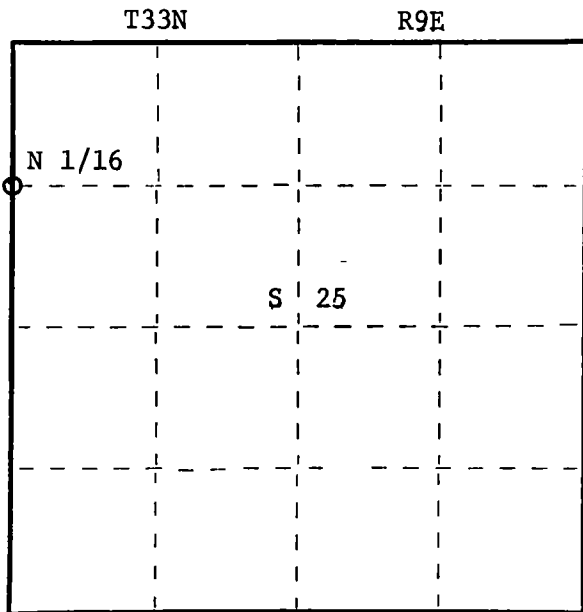

○ = Corner monument restored.

Dated at Rhineland, Wis., this 11th day of May, 1983.

Signature: *Glen Barker* Title: Registered Land Surveyor Registration No. S1682
(County Surveyor, Registered Land Surveyor, or other duly authorized official)

Office of Register of Deeds, County of _____, I hereby certify that the within
instrument was filed in this office for record on the _____ day of _____, 19____
at _____ o'clock _____ M.

(Register of Deeds)

By _____ Deputy

FORM 985 H.C. Mining Company Stock No. 26272