

CERTIFIED LAND CORNER RESTORATION

Index No. U-21

State of Wisconsin }
Langlade } ss.
County of

History of original corner establishment:

No evidence of any previous corner.

I, Glen Barker, do hereby certify that on the 22nd day of February, 1983, I ~~found~~ found evidence of the S 1/16 corner of Sections 25 & 26 Township 33, North, Range 9 East, Fourth Principal Meridian, as described hereon; and that from this evidence I established a new monument and accessories as described hereon to perpetuate the original location of this corner.

Description of corner evidence found:

Total distance from section corner 25-26-35-36 to previously established 1/4 corner between sections 25 & 26 is 2715.68 ft.
Set S 1/16 1357.84 ft. intermediate.

Resident witnesses:

J. Claflin - R.....

H. Wagoner

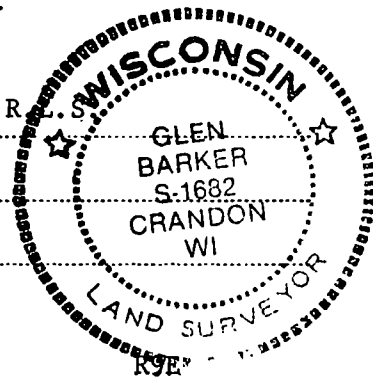

Description of monument and accessories I established to perpetuate the original location of this corner.

Set a 1" iron pipe with 2" diameter alloy cap stamped: S1682
Monument projects 12" above ground. T33N R9E
Marked NBTs S 1/16 26 25
Sugar 7" N38E 13.00 ft.
Sugar 10" S88E 17.69 ft.
Scribed 1/16 - B.T. CPI - 1983

FORM 985
Revised 12/82
Wisconsin Department of Natural Resources
Stock No. 26272

T33N

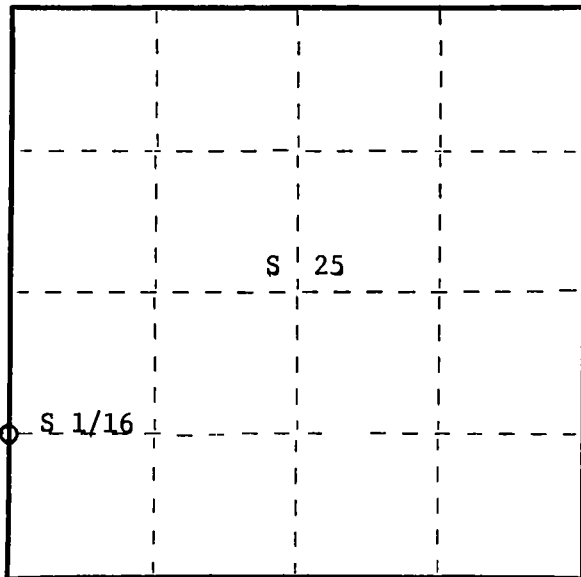

○ = Corner monument restored.

Dated at Rhineland, Wis., this 11th day of May, 1983

Signature Glen Barker Title Registered Land Surveyor Registration No. S1682
(County Surveyor, Registered Land Surveyor, or other duly authorized official)

Office of Register of Deeds, County of, I hereby certify that the within instrument was filed in this office for record on the day of, 19..... at o'clock M.

.....
(Register of Deeds)

By Deputy