

CERTIFIED LAND CORNER RESTORATION

Index No. V-22

State of Wisconsin }
County of Langlade } ss.

History of original corner establishment:

No evidence of any previous corner.

I, Glen Barker, do hereby certify that on the 10th day of February, 1983, I found evidence of the W 1/16 corner of Sections 25 & 36 Township 33 North, Range 9 East, Fourth Principal Meridian, as described hereon; and that from this evidence I established a new monument and accessories as described hereon to perpetuate the original location of this corner.

Description of corner evidence found:

Total distance from section corner 25-26-35-36 to 1/4 corner between sections 25 & 36 is 2352.49 ft. Set W 1/16 1176.24 ft. intermediate.

Resident witnesses:

J. Claflin - R.L.S.

H. Wagoner

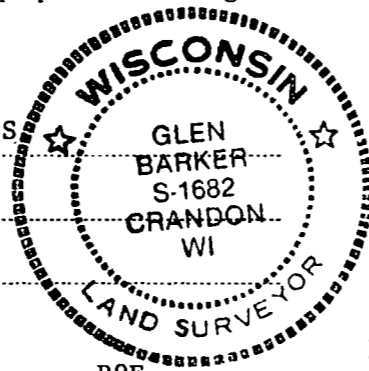

Description of monument and accessories I established to perpetuate the original location of this corner.

Set a 2" iron pipe with brass cap stamped:

T33N R9E

Monument projects 12" above ground

Marked NBTs

Maple 6" S86E 23.49 ft.

Maple 6" S15W 20.09 ft.

Scribed 1/16 - B.T.

W 1/16 S 25
S 36

S1682 - 1983

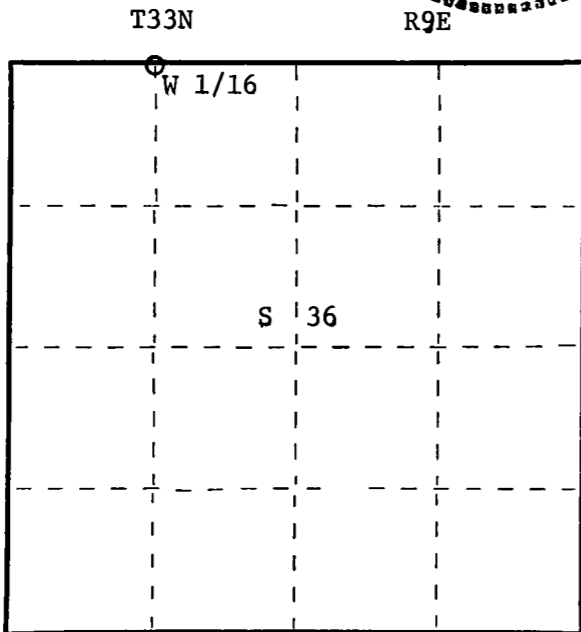

○ = Corner monument restored.

Dated at Rhineland, Wis., this 11th day of May, 1983.

Signature: *Glen Barker* Title: Registered Land Surveyor Registration No. S1682
(County Surveyor, Registered Land Surveyor, or other duly authorized official)

Office of Register of Deeds, County of _____, I hereby certify that the within instrument was filed in this office for record on the _____ day of _____, 19____ at _____ o'clock _____ M.

(Register of Deeds)

By _____ Deputy

Stock No. 26272

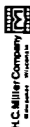

FORM 985