

CERTIFIED LAND CORNER RESTORATION

Index No. J-19

State of Wisconsin }  
 County of LANGLADE } ss.

I WILLIAM F. KELLY, do hereby certify that on the 17<sup>th</sup> day of DEC, 1981, I found evidence of the S. 1/4 corner of SEC. 11 Township 33, North, Range 9 EAST, Fourth Principal Meridian, as described hereon; and that from this evidence I established a new monument and accessories as described hereon to perpetuate the original location of this corner.

Resident witnesses:

BEN KING

History of original corner establishment:

ORIGINAL CORNER ESTABLISHED BY  
 HIRAM C FELLOWS IN SEPT-OCT, 1860.

CCC RESURVEY IN 1938 SET  
 BRASS CAP MONUMENT

Description of corner evidence found:

4" BRASS CAP MONUMENT,  
 FOUND IN PLACE.  
 MARKED 3 BT'S.

RES. WITNESS IDENTIFIED  
 CORNER LOCATION

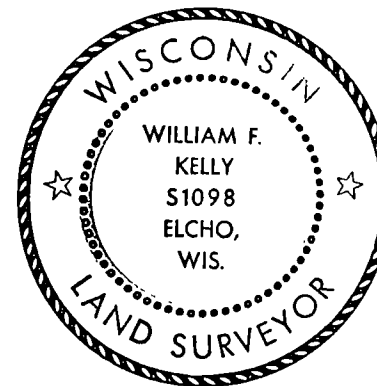

Description of monument and accessories I established to perpetuate the original location of this corner.

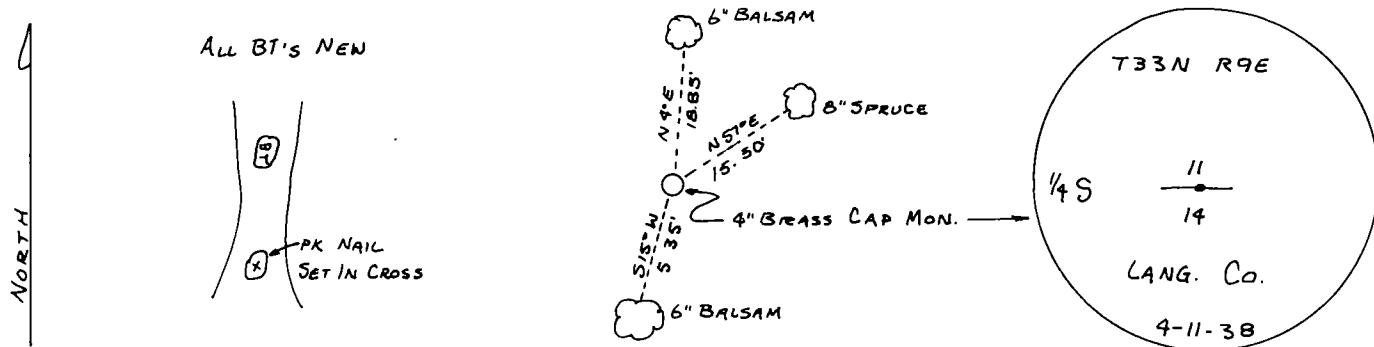

FORM 985 H. C. MILLER CO., MILWAUKEE

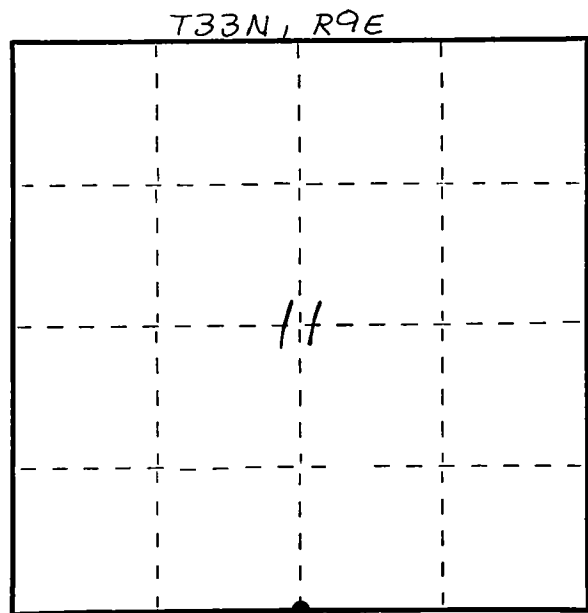

○ = Corner monument restored.

Dated at ELCHO, Wis., this 17<sup>th</sup> day of DEC, 1981

Signature William F. Kelly Title COUNTY SURVEYOR Registration No. 1098  
 (County Surveyor, Registered Land Surveyor, or other duly authorized official)

Office of Register of Deeds, County of \_\_\_\_\_, I hereby certify that the within instrument was filed in this office for record on the \_\_\_\_\_ day of \_\_\_\_\_, 19\_\_\_\_ at \_\_\_\_\_ o'clock \_\_\_\_\_ M.

(Register of Deeds)

By \_\_\_\_\_ Deputy