

CERTIFIED LAND CORNER RESTORATION

339

Index No. H-17

State of Wisconsin }
County of Lanlade } ss.

I, Raymond J. Hallisy, do hereby certify that on the 10th day of June, 1968, I found evidence of the S 1/16 corner of Section 10 Township 33, North, Range 9, Fourth, Principal Meridian, as described hereon; and that from this evidence I established a new monument and accessories as described hereon to perpetuate the original location of this corner.

Resident witnesses:
.....
.....
.....

FORM 985 H. C. MILLER CO., MILWAUKEE

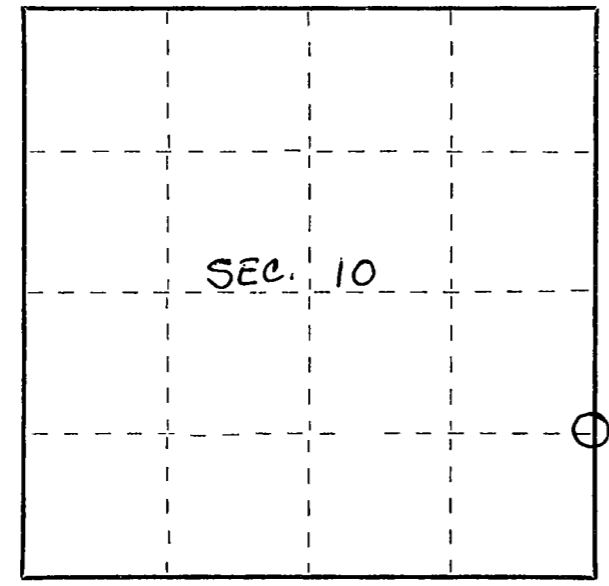

○ = Corner monument restored.

History of original corner establishment:

Corner set in the 1930's

Description of corner evidence found:

Found squared stake down, point intact.
Marked S10 S11 30 LKS E

Description of monument and accessories I established to perpetuate the original location of this corner.

Set Std. 1 1/2" pipe with cap marked W.C. C. 30 LKS. E.
BT's to witness corner.

10" RED MAPLE SCRIBED BT
N60°W 10' 5" → ○

8" RED MAPLE SCRIBED BT
S72°W 14' 8" → ○

ONE MILE RD

Dated at Artigo, Wis., this 10th day of June, 1968

Signature Raymond J. Hallisy Title Reg. Land Surveyor Registration No. 4685
(County Surveyor, Registered Land Surveyor, or other duly authorized official)

Office of Register of Deeds, County of _____, I hereby certify that the within instrument was filed in this office for record on the _____ day of _____, 19____ at _____ o'clock _____ M.

.....
(Register of Deeds)

By.....Deputy