

PRESERVATION OF LANDMARKS

SECTION 59,635(7) WISCONSIN STATUTES

COUNTY LANGLADE

TOWN SUMMIT

HIGHWAY COUNTY "H"

SECTION NO.'S 9 & 10

T. 33 N., R. 9 E.

TYPE OF LANDMARK 1/16 CORNER

LOCATION INDICATED ON SKETCH X

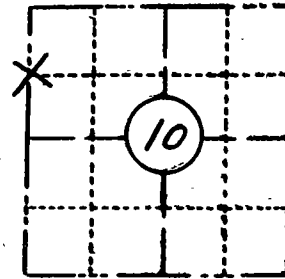

LOCATION SKETCH

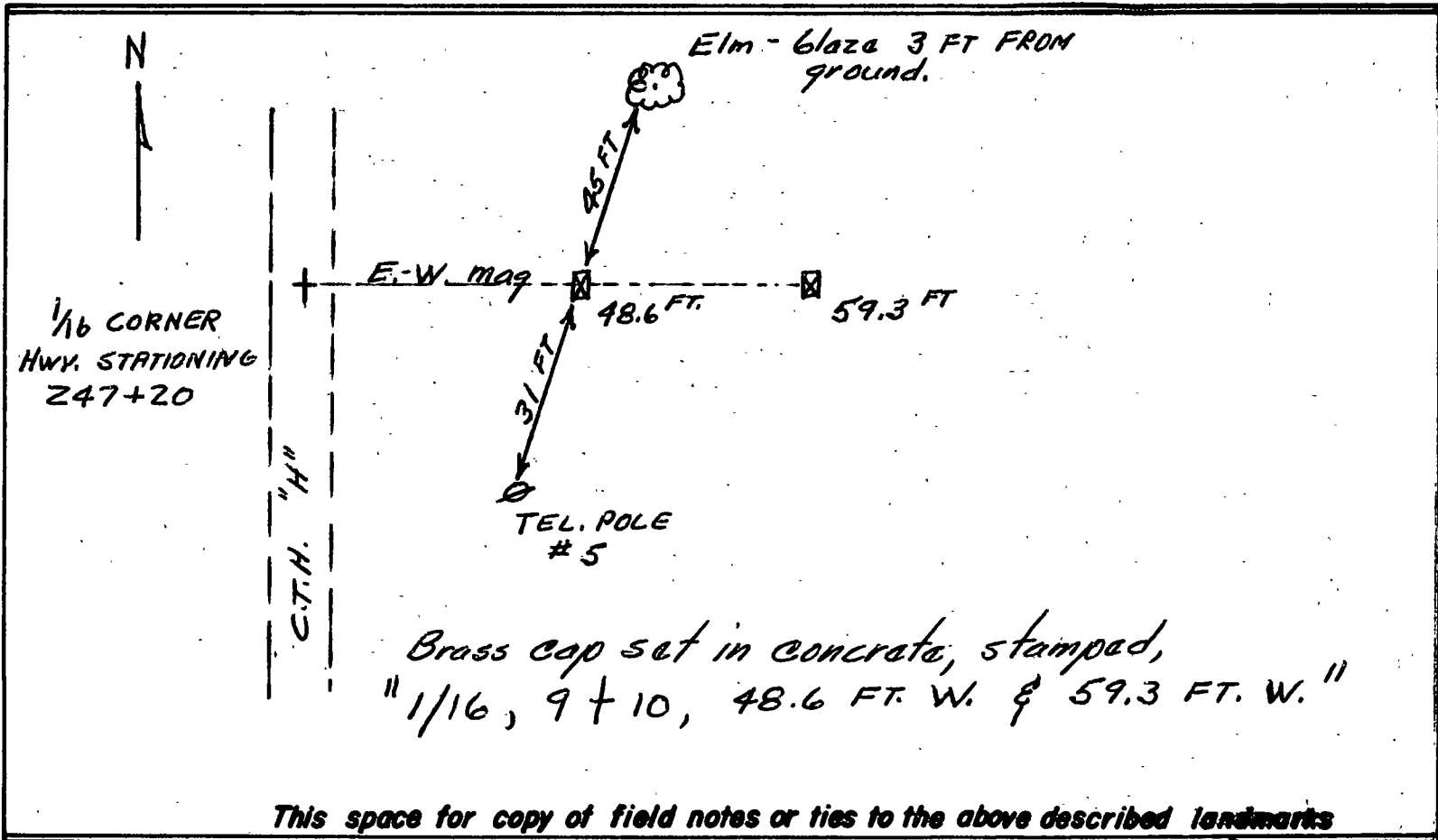

Field notes or records, filed in book no. 8615
 at the State of Wisconsin Hwy Commission office.
 City of Rhinelander Oneida County.
 Located or established by Paul M Johnson, 1962.
 Title Engineer II

County Clerk's Office _____ County, Wis. } ss
 Received for record Sept 18, 1962
 Copy sent to County Surveyor _____, 19____

 County Clerk

F13