

CERTIFIED LAND CORNER RESTORATION

Index No. J-5

State of Wisconsin } ss.
County of LANGLEADE

I, WILLIAM F. KELLY, do hereby certify that on the 7th day of DECEMBER, 1982, I found evidence of the SE corner of SECT. 7 Township 33 North, Range 9 EAST, Fourth Principal Meridian, as described hereon; and that from this evidence I established a new monument and accessories as described hereon to perpetuate the original location of this corner.

Resident witnesses:

WILLIAM WILDMAN

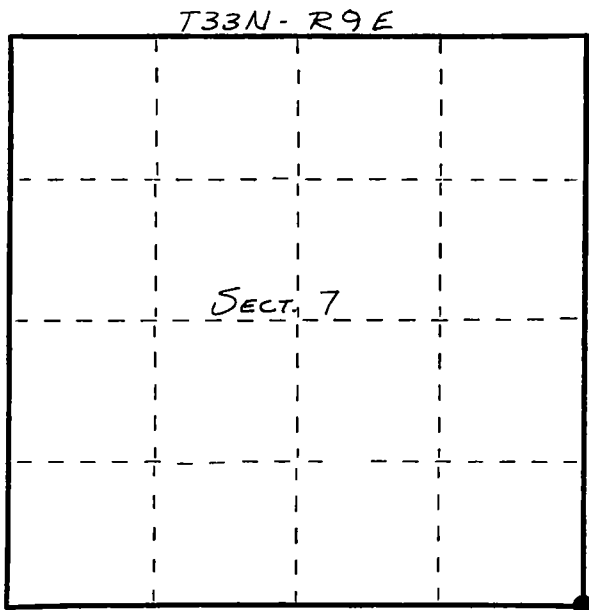

○ = Corner monument restored.

History of original corner establishment:

ORIGINAL CORNER ESTABLISHED BY
HIRAM C. FELLOWS IN SEPT.-OCT., 1860.

Description of corner evidence found:

FOUND IN PLACE: 4" BRASS CAP
MONUMENT. MARKED 3 BT'S.
MON. EST. BY CCC IN 1938

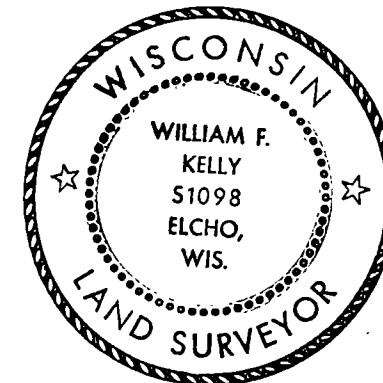

William F. Kelly
12-14-82

Description of monument and accessories I established to perpetuate the original location of this corner.

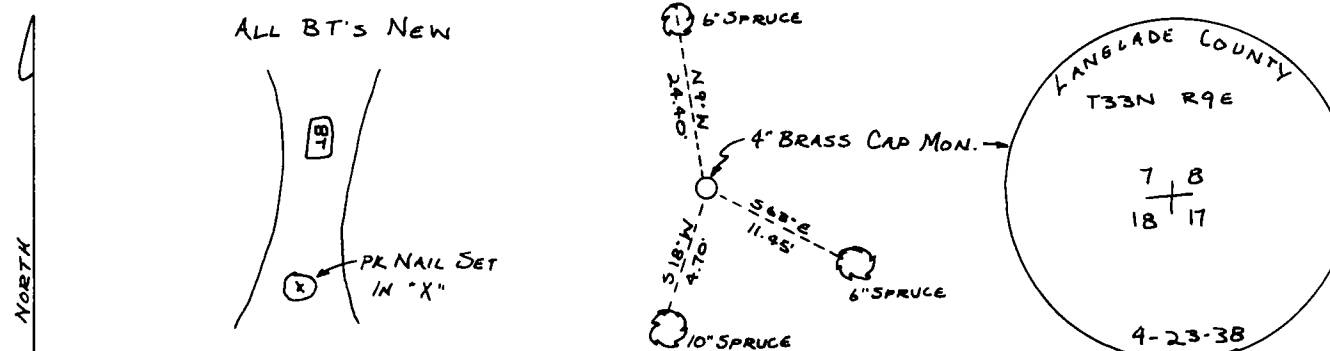

Dated at ELCHO, Wis., this 7th day of DECEMBER, 1982

Signature William F. Kelly Title COUNTY SURVEYOR Registration No. 1098
(County Surveyor, Registered Land Surveyor, or other duly authorized official)

Office of Register of Deeds, County of _____, I hereby certify that the within instrument was filed in this office for record on the _____ day of _____, 19____ at _____ o'clock _____ M.

(Register of Deeds)

By _____ Deputy